

# Princess X90

Product Presentation



  
Distinction in Detail

# Contents



03 Overview

Technical Overview

04-56 Model in Detail

Highlights

Profile

Exteriors

Interiors

Layouts

Technical Information

Specifications

57-60 Optional Upgrades

61 Further information

# Technical Overview

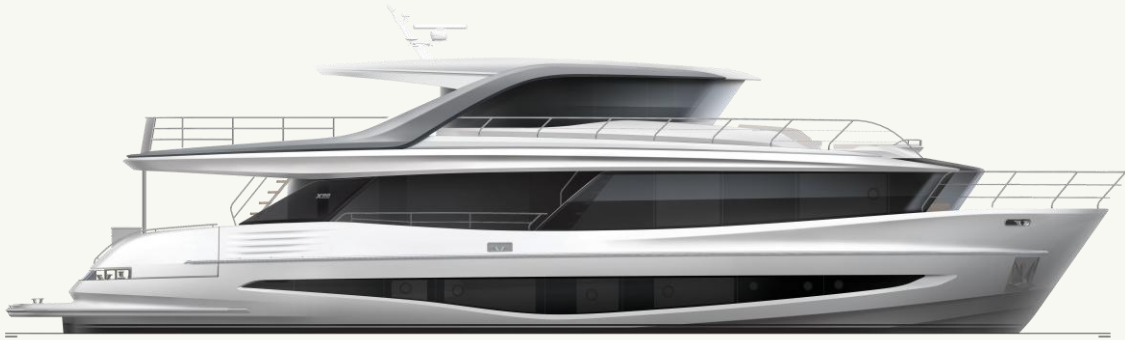

## Principal Dimensions

Length overall (incl. Pulpit)	87' 10"	26.77m
Length overall (excl. pulpit)	87' 10"	26.77m
Beam	21' 8"	6.62m
Draft approx. (at full load)	5' 10"	1.79m
Displacement approx. (at half load)	91,442kg	201,595 lbs
Fuel capacity	2,491 gal / 2,905 US gal / 11,000 l	
Water capacity (excl. calorifier)	330 gal / 396 US gal / 1,500 l	
Hot water calorifiers	66 gal / 79 US gal / 300 l	
Black water tank	132 gal / 158 US gal / 600 l	
Grey water tank (optional)	308 gal / 370 US gal / 1,400 l	

## Engines and Performance

Twin MAN V12-1900 (2 x 1,900mhp)  
Twin MAN V12-2000 (2 x 2,000mhp)

Max speed range 23-25 knots  
Max speed range 24-26 knots

Range

10 knots up to >1,200 nm  
20 knots up to 350 nm

## Systems and Hardware

- SEABOB storage x 2
- Williams 460 on Platform, up to 700kg
- Seakeeper 40 or Sliepner VF 1650 fins
- 1,150l extended range tank option
- 550kgf bow and 420kgf stern, hydraulic thrusters
- 2 x 105kg Kedge anchors with 100m of 14mm chain
- Hotel Services Option 100kWh Capacity
  - Hotel services/silent running li-ion battery system with 121kWh capacity
  - System includes 48v li-ion battery pack
  - 36kVA bank of inverter/chargers, and all necessary power electronics. Capable of running all hotel services off batteries alone, including managed usage of air conditioning.

# Model in Detail

# Highlights

- 2 MAN engine options providing speeds up to 26 knots
- Three distinct external entertaining zones:
  - Spacious aft Skydeck, partially covered by canopy overhang, with 5 unique layout options including the standard twin sofas and coffee tables, an aft wetbar, loose furniture arrangement, a spa bath, and a Skydeck tender crane
  - Skydeck foredeck featuring forward and aft facing U-shaped seating areas with flip up back rests and coffee table
  - Aft cockpit area featuring port, starboard and aft facing upholstered seating with coffee tables, starboard wetbar unit with optional fit out
- Enclosed Skylounge featuring large port side sofa with coffee table, starboard sofa, optional day head, and enclosed wheelhouse (via sliding doors) housing the helm station
- New style main deck layout featuring aft dining area and midships saloon, enclosed or open galley, day head, and main deck master stateroom to forward
- Below deck, guest accommodation features 3 ensuite double cabins as standard with the option to specify two ensuite twin cabins in lieu of the lower deck forward stateroom, whilst crew quarters feature up to 3 crew cabins, crew bathroom, and crew mess area with seating and galley
- Tender can be carried and launched with ease due to electro-hydraulic raise/lower bathing platform (700kg SWL) and optional Skydeck crane

# Profile

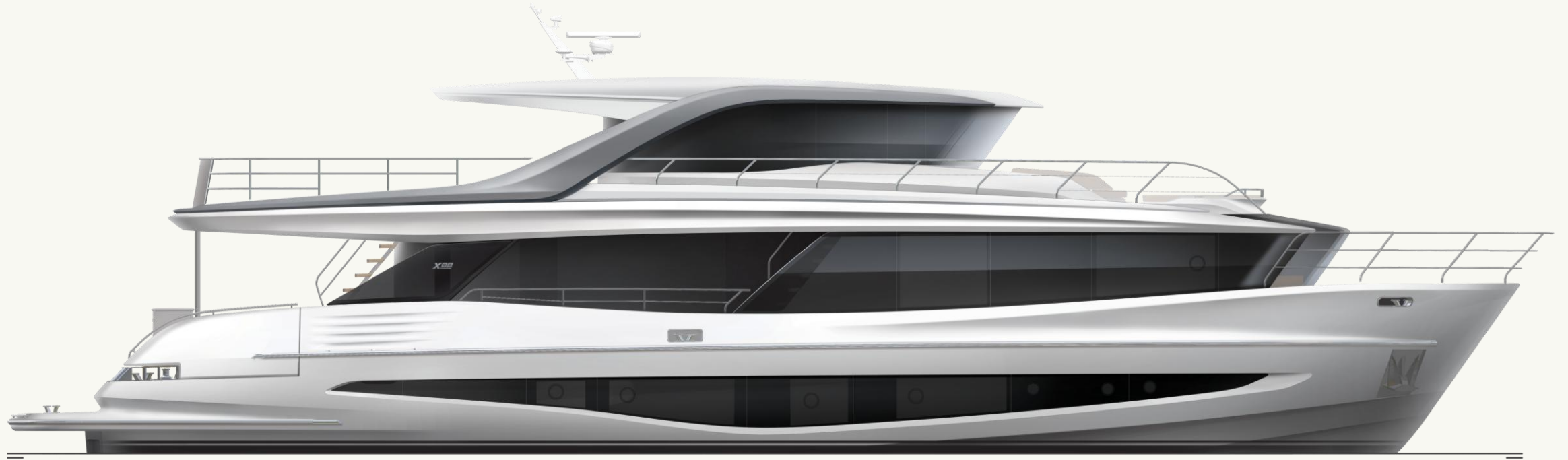

# Profile Options

Profile showing Allure styling option.

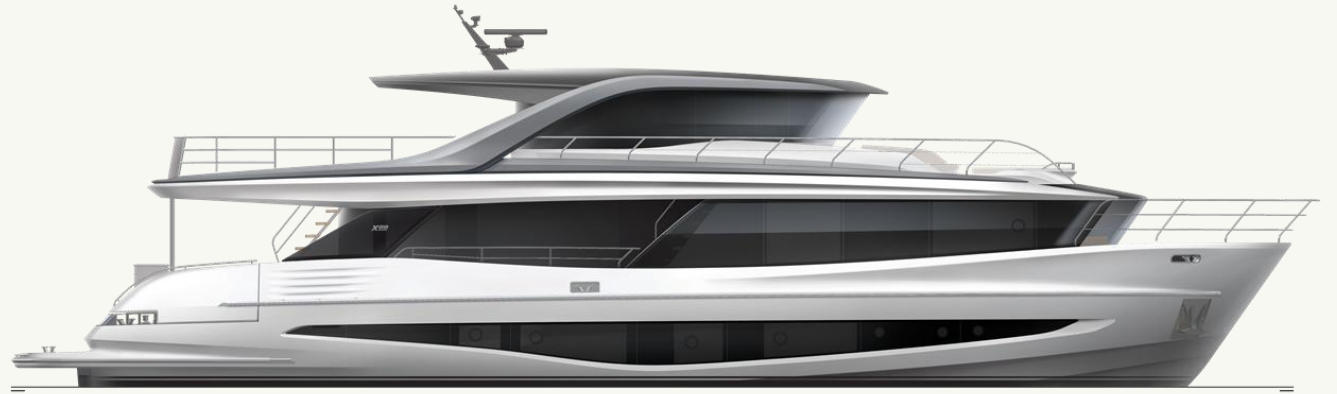







Flybridge



Flybridge with optional wetbar



Flybridge with optional furniture



Flybridge with optional spa bath



Transom with optional fold down balconies



Cockpit with optional fold down balconies



Cockpit with optional fold down balconies



Cockpit with optional spa bath and fold down balconies



Cockpit with optional spa bath and fold down balconies



Foredeck with flip up backrests



Foredeck with sunpad infill



Wheelhouse



Skylounge



Skylounge with optional TV



Skylounge (looking forward)



Skylounge (looking forward) with optional TV



Dining Area



Dining Area (with optional open galley)



Saloon



Saloon (with optional open galley)



Saloon TV unit



Saloon TV unit (with optional open galley)



Saloon



Owner's Stateroom



Owner's Stateroom



Owner's Stateroom Bathroom

# Standard Layouts

Flybridge, main deck and lower deck standard arrangements.

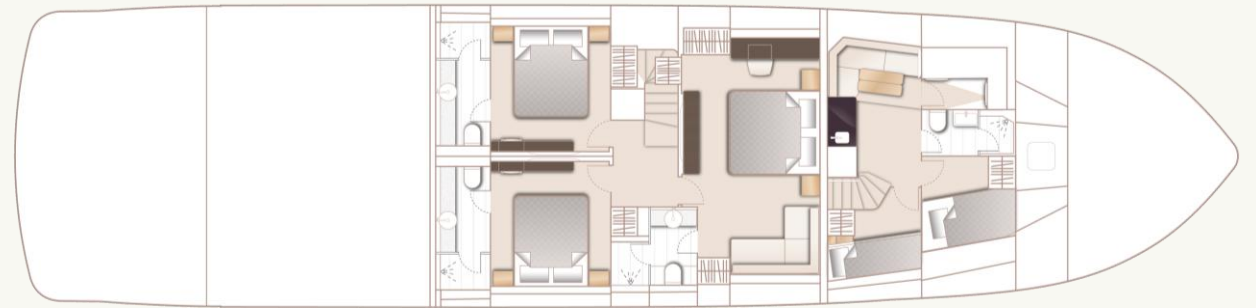
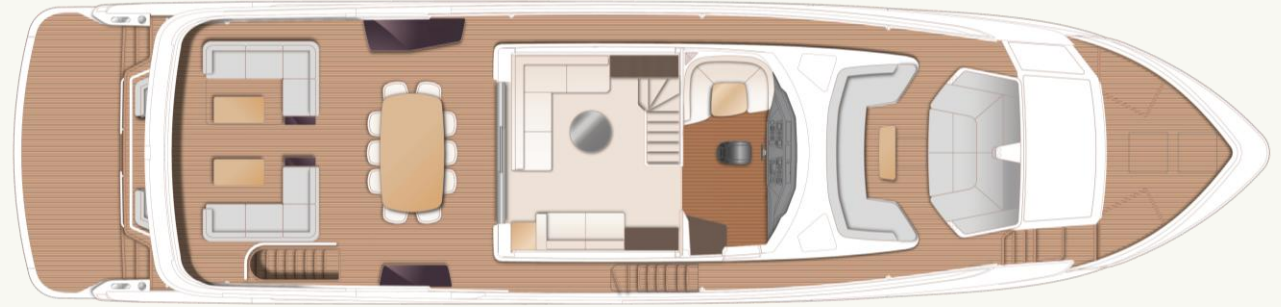

# Optional Layouts

Optional flybridge layouts showing optional day head and additional helm seat (top) and optional aft deck arrangements.

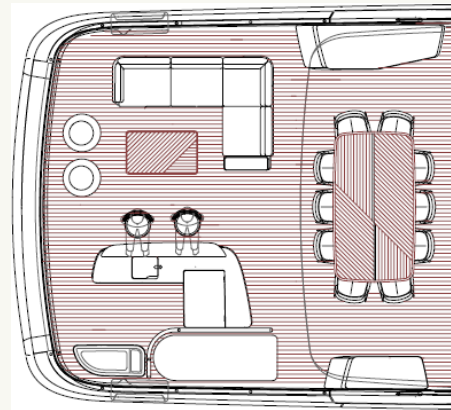
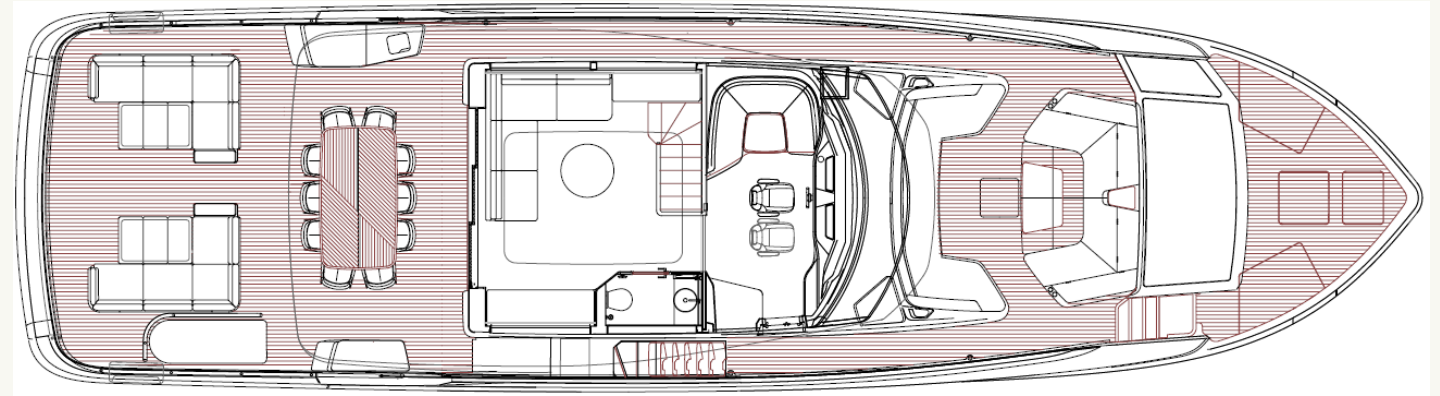

Optional aft wetbar, storage/coolbox and bar stools

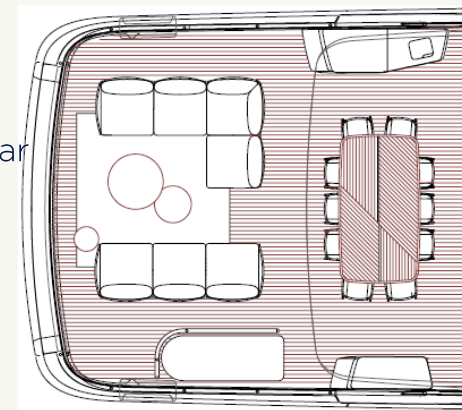

Optional furniture arrangement with Nodi L-shape soft and Roda Harp dining chairs

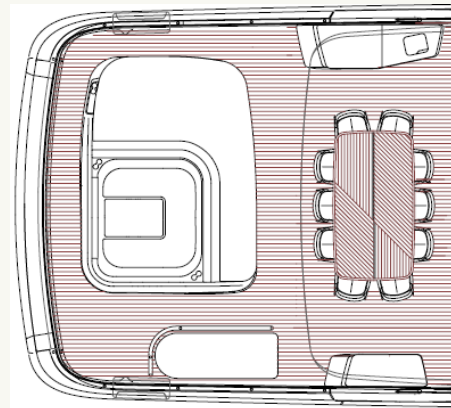

Optional spa bath

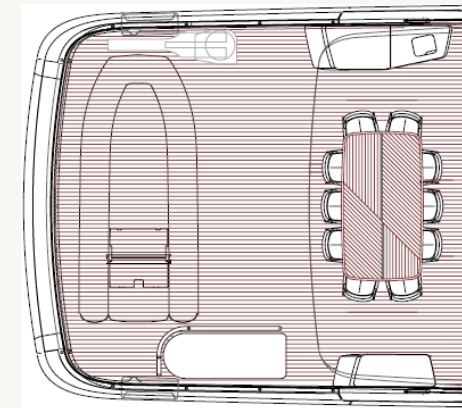

Optional tender crane

# Optional Layouts

Optional main deck layouts showing the following optional arrangements:

- Top: Optional drop balconies, cockpit TV, 8-10 person dining table, open galley, bar stools, sideboard in lieu of owner's sofa and gullwing door forward of owner's dressing table.
- Bottom: Optional cockpit spa bath

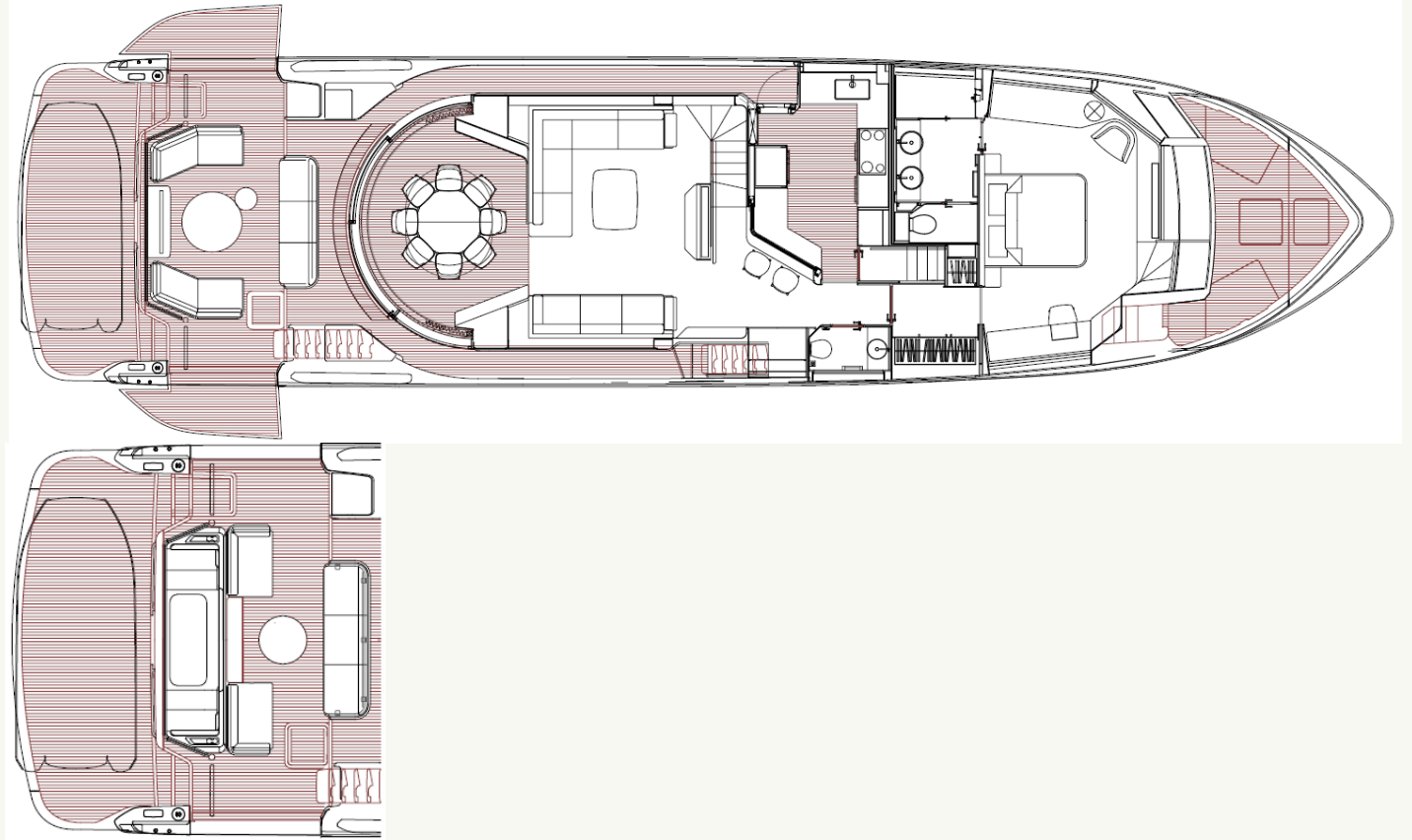

# Optional Layouts

Optional lower deck layout showing optional four cabin lower deck arrange three cabin crew arrangement and optional lazarette with hotel services battery.

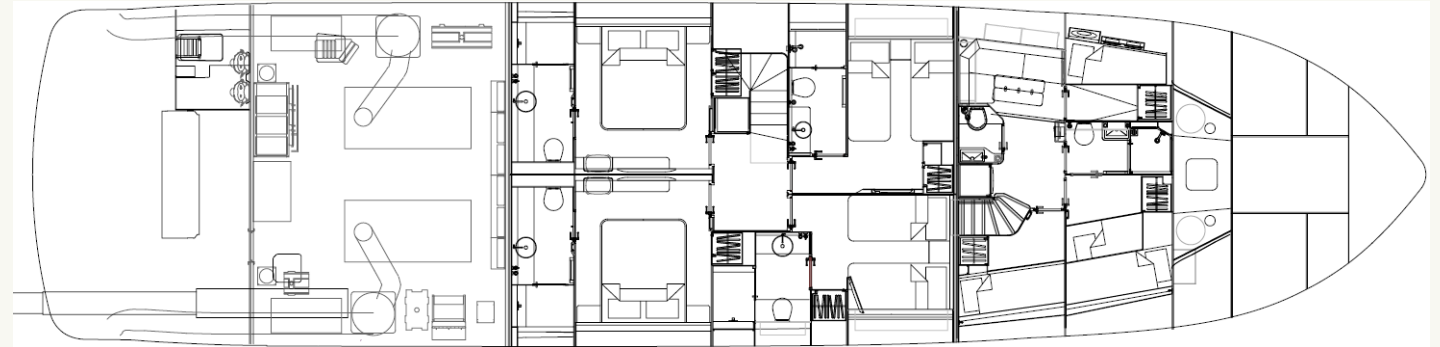

# Flybridge

Wetbar with double electric BBQ, drawer fridge, sink and tap, waste bin and storage

L-shaped sofa and coffee table

U-shaped companion seating with dinette table

Skydeck foredeck with forward and aft facing u-shaped seating areas with flip up back rests and coffee table (with sunpad infill cushion to forward seating area)

Twin L-shaped sofas with coffee tables (2)

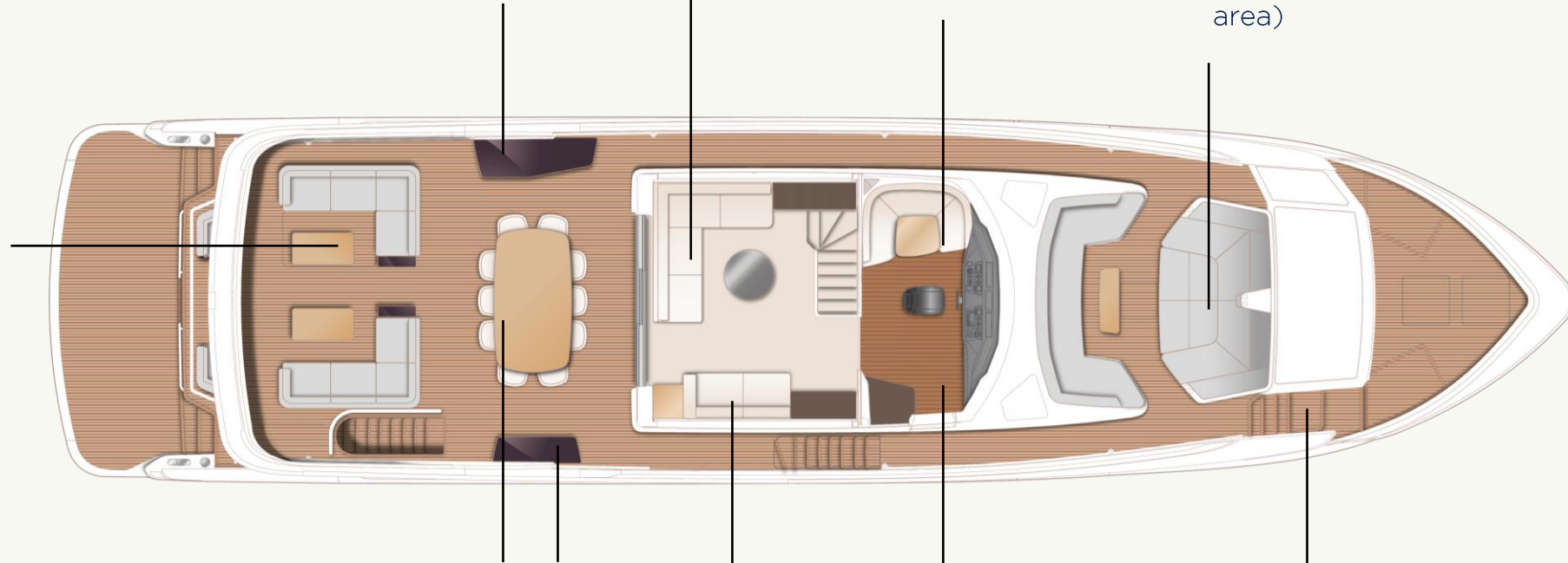

Dining table with chairs to accommodate 8 persons (10 for optional 5 cabin layout)

Wetbar with storage

Sofa and sideboard with fridge and storage

Enclosed wheelhouse (via sliding doors) with central leather upholstered electric seat

Access stairway to foredeck mooring and anchoring equipment

# Main Deck

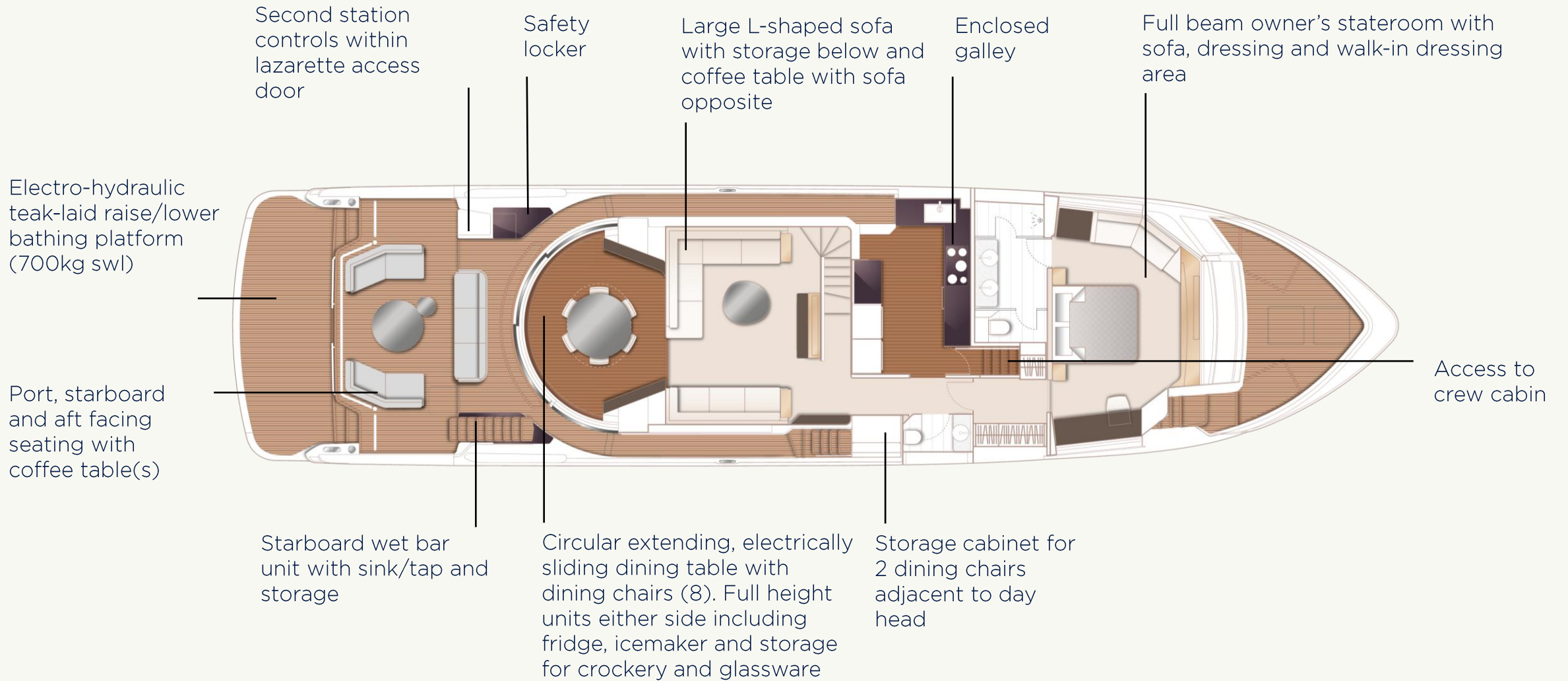

# Lower Deck

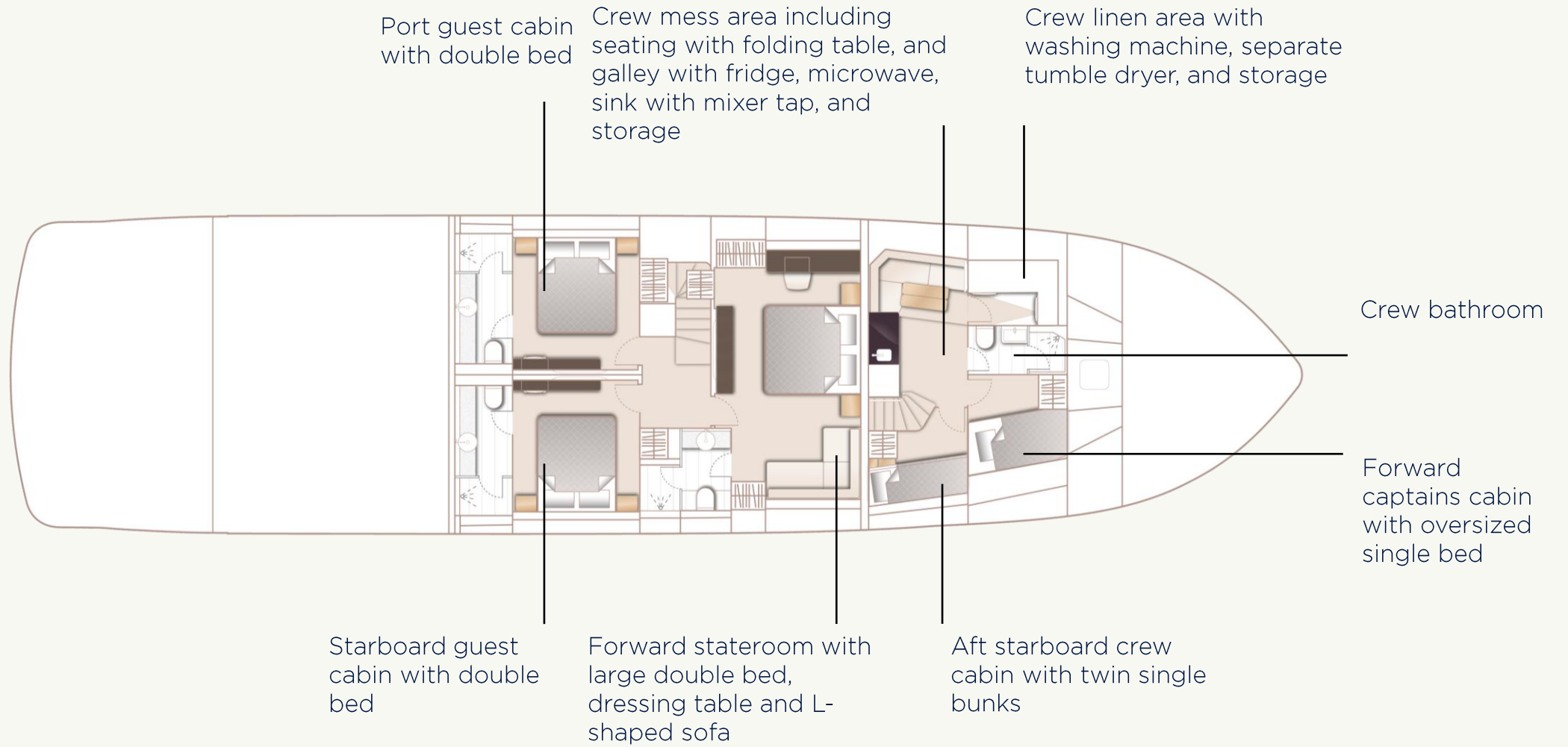

# Styling Highlights



## Dining Table Top

A contemporary taupe glass finish has been specified for the saloon dining table. The reflective element enhances the space and light as you enter the main deck saloon.



## Feature timber

An elegant Graphite timber has been carefully selected and is fitted to feature accents throughout the boat. The saloon bookcase, TV unit and accent window box features to compliment the selected boat timbers and elevate the styling aboard



## Lacquer Detailing

Lacquer trim detailing is fitted to door inlays, vanity and unit recesses to key areas enhance the finish and warm palette offered within the standard material specification.



## Tinted Glass & Mirrors

The use of bronze and grey tint glass with mirror accents can be seen throughout the boat. Bronze glass wardrobe doors to all cabins with a refined printed detail to Main deck cabin to elevate this space.

# Styling Highlights



**Saloon bookcase**

An elegant bookcase design provides a sophisticated feature and has been specified with a graphite timber frame and tan contrast back panelling upholstery with recessed lighting to enhance the boat styling.



**Saloon coffee table**

A Princess Design Studio coffee table has been designed inhouse to enhance the saloon functionality and design. A carefully selected quartzite top offers a complimentary partner to the sleek graphite timber frame and secondary top finish.



**Optional open galley bar stools**

Poliform Ventura low stools have been specified to the optional open bar with a contemporary Black Elm frame finish and owners choice upholstery.

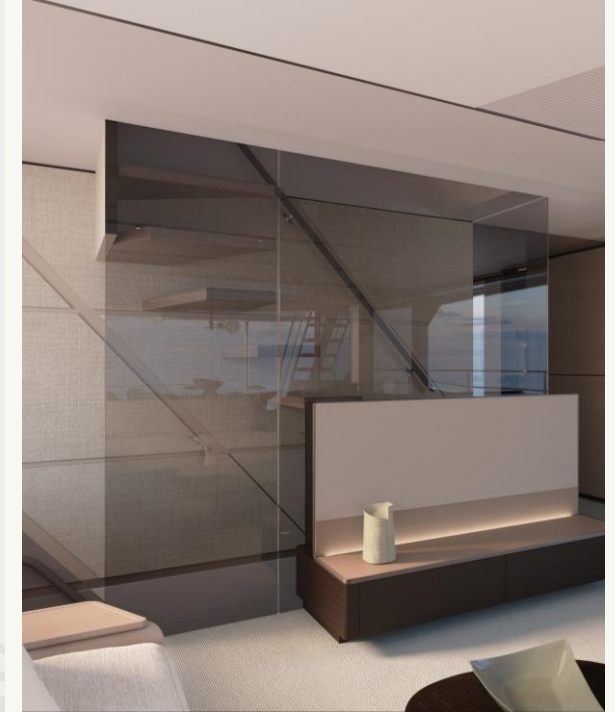

**Staircase Feature**

The forward saloon offers an elevated styling package with floating staircase and grey tint glass panelling aft. A textured wallcovering with accent feature detailing to the staircase bulkheads have been specified in neutral tones to offer a relaxed aesthetic.

# Bathroom Styling



## New styling direction

The new design will offer a contemporary and fresh aesthetic, with an elegant palette inclusive of bronze detail accents and tinted shower glass with an elevated Hans Grohe hardware specification.

The optional marble uplift package remains an option, please see option forms for further details.



## Hardware

Vanity and shower hardware is specified as standard in brushed black chrome finish to compliment the area and materials specified for the bathrooms



## Materials

All bathrooms have Porcelain Cotton finish to bathroom floors and feature bulkheads where applicable as standard (other colours available - please see Design Studio), with quartz Organic White worktops and splashbacks fitted as standard in a honed finish with surface mounted sinks in satin white

# Princess Connect Telemetry and Maintenance

For peace of mind we provide a telemetry and transparent maintenance system called Princess Connect as standard on all of our new yachts.

Designed to keep your yacht in continuous communication with you or your captain, your local dealer and our shipyard, it provides remote monitoring anywhere in the world.

In addition to increased control on-board, Princess Connect acts as your virtual service operator, providing personalised notifications on upcoming maintenance requirements, a digital library of all user guides and manuals plus further support information.

Princess Connect gives you access to:

- GPS tracking
- Engine and generator data, including running hours
- Internal temperature and humidity
- Tank levels
- Electrical data including battery and shore power
- Security and bilge alarms
- Previous navigation data



# Standard Specification

## Principal Dimensions

Length overall (inc. pulpit) 88 ft 11 in / 27.11m

Length overall (excl. pulpit) 87 ft 10 in / 26.77m

Beam 21 ft 8 in / 6.62m

Draft 5 ft 10 in / 1.79m

Displacement approx. 91,442 kg / 201,595 lbs\*

Fuel capacity 2,419 gal / 2,905 US gal / 11,000 l

Water capacity (excl. calorifier) 330 gal / 396 US gal / 1,500 l

Black water tank 132 gal / 158 US gal / 600 l

## Engines – Diesel

Twin MAN V12-1900 (2 x 1,900mhp)  
Maximum speed range – 23-25 knots<sup>†</sup>

Twin MAN V12-2000 (2 x 2,000mhp)  
Maximum speed range – 24-26 knots<sup>†</sup>

<sup>†</sup> Maximum speeds will vary depending on cleanliness of hull, condition of sterngear, loading of craft, water and air temperatures, sea conditions and other factors. Speed estimates are therefore given in good faith but without warranty or liability on the part of Princess Yachts Limited. Craft illustrated in this brochure may be fitted with certain optional equipment. Specifications may be changed at any time without notice or liability.

\* Displacements are calculated with 50% fuel and water with life raft but with no optional equipment fitted or other gear.

# Detailed Specification

## Deck fittings

- 6mm teak-laid transom platform, transom steps, cockpit deck, stairway to flybridge, side decks, steps to foredeck, foredeck, flybridge aft sun deck and foredeck seating walkthrough areas
- Hydraulic anchor windlasses (within deck locker) with foredeck and main helm controls
- Twin stainless steel anchor pockets with hawse pipes incorporating two 105kg galvanised kedge anchors with 100m of 14mm galvanised chain
- Twin electric stern line mooring winches
- Deck hatch access to Bosun's locker
- Freshwater deck/anchor wash (with fore, aft and flybridge deck outlets)
- Stainless steel bow and stern fairleads
- Stainless steel foredeck bollards (2 pairs, port and starboard)
- Stainless steel amidships spring bollards (2 pairs, port and starboard)
- Stainless steel aft bollards (1 pair, port and starboard)
- Stainless steel transom bollards (1 pair, port and starboard)
- Stainless steel guard rails to foredecks (1m high in order to comply with MCA MGN 280)
- Stainless steel flybridge oval handrails with glazed panel to aft (1m high in order to comply with MCA MGN 280)
- Stainless steel oval handrails to main deck side decks (1m high in order to comply with MCA MGN 280)
- Foredeck escape hatch
- Twin coach roof lockers for storage of fenders, ropes and cushions
- PVC rubbing band with stainless steel insert
- LED deck level lighting
- Full set of IMO navigation lights
- Twin beam searchlight with remote controls
- Stern docking lights
- Twin electric horns
- Fuel and water fillers

## Aft cockpit and bathing platform

- Self-draining
- Port, starboard and aft facing upholstered seating with coffee table(s)
- LED overhead and deck level lighting
- Stainless steel handrails (1m high in order to comply with MCA MGN280)
- Stern docking (second) station controls port side including engine controls, thruster controls, windlass controls and emergency engine stops
- Remote control 4.4m telescopic passerelle with automatic folding handrails (1.4m overhang)
- Deck hatch giving access from bathing platform into lazarette
- Main cockpit access to engine room
- Engine room to cockpit escape hatch
- Stern lazarette and central transom locker
- Wash basin with mixer tap in starboard wet bar unit
- Port safety locker containing remote fuel cocks, manual bilge pump with valve chest and manual controls for automatic fire extinguisher
- Integral stairway to flybridge with teak step treads
- Twin transom gates leading to bathing platform
- Electro-hydraulic teak-laid raise/lower bathing platform (700kg SWL) with Princess logo in bathing platform teak
- Retractable bathing ladder (manual) in bathing platform with pop-up handles
- Hot and cold transom shower
- 220/240v shore support inlet
- Cockpit seat cover and table cover
- Lufftrack for optional cockpit cover or optional privacy screen
- Steps to BP with decking

## Helm

- Enclosed wheelhouse (via sliding doors) with central leather upholstered electric seat with fore, aft and electric/manual height adjustment

- U-shaped companion seating to port (with dinette table)
- Two stage sliding door to fully enclose or open helm to sky lounge area
- Instrument console with LCD display incorporating engine instruments, fuel gauges, alarms and rudder position indicator
- Helm position instrument and controls console including:
  - power-assisted electro-hydraulic steering (SeaStar)
  - adjustable steering wheel
  - high-speed magnetic compass
  - electronic engine controls
  - bow thruster control
  - anchor winch remote control
  - colour radar (with scanner) and GPS/chart plotter (twin 19" displays), with 15" Böning control screen
  - autopilot
  - speed and distance log
  - echo sounder with alarm
  - VHF with DSC R/T with intercom
  - remote control dual searchlight
  - horn button (to operate twin electric horns)
- audible and visual alarm for bilge pumps
- engine room fire extinguisher warning system
- Automatic fog horn with loudhailer
- Chart storage and table
- Drink holders
- Toughened glass screen (clear for night vision) with windscreen de-mist system
- Windscreen wipers with freshwater windscreen wash
- Exterior black mesh windscreen covers
- Bilge pump controls with visual pump running warnings
- 24v and 240v electrical control panel
- Helm and navigation light control switches
- Dimmable LED overhead/concealed lighting (24v) and night lighting
- Watertight pantograph door giving direct access to starboard side foredeck walkthrough area
- Drop window to portside of Skydeck wheelhouse
- Timber-laid flooring (V-groove planked)
- 220/240v outlets (1)
- USB charging points (2) (1x USB-A and 1x USB-C)

### Sky lounge

- Portside L-shaped sofa and coffee table
- Sofa to starboard side
- Sideboard with fridge and storage
- Naim Uniti Atom audio system with Focal 100 ICW6 speakers (2)
- Access stairway to main deck
- 3 panel (2 moving, 1 fixed) stainless steel opening glass patio doors to aft deck area
- Dimmable LED overhead/concealed lighting (24v) with scene selection
- Tinted panoramic toughened side windows
- Tinted glazed roof panels with electric blinds (TBC)
- Electric sheer roller blinds to all side windows
- Integrated, pleated blind to skylounge aft patio door
- Timber-laid flooring (V groove planked), with rug inlay
- 220/240v outlets (1)

- USB charging points (2) (1x USB-A and 1x USB-C)

### Skydeck foredeck

- Skydeck foredeck with forward and aft facing U-shaped seating areas with flip up back rests and coffee table (with sunpad infill cushion to forward seating area)
- Bow storage lockers
- Drinks holders
- Access on starboard side to foredeck mooring and anchoring equipment

### Skydeck aft

- Twin L-shaped sofas with coffee tables (2)
- Dining table with chairs to accommodate 8 persons (10 for optional 5 cabin layout)
- Naim Uniti Atom audio system with JL Audio M6-650X-L waterproof speakers (2) to sky deck aft
- Clear view hatch to aft cockpit
- Access stairway to aft cockpit
- Stainless steel oval handrails with glass balustrade to aft of Skydeck (1m high in order to comply with MCA MGN280)

- Portside wetbar with double electric BBQ, drawer fridge, sink and tap, waste bin and storage with Solid Surface counter top
- Starboard wetbar with storage
- LED overhead and deck level lighting
- Life raft stowage for two 10-man SOLAS B life rafts in self-contained cannisters
- Radar mast
- Twin matching whip aerials for VHF R/T and radio

#### Deck saloon

- Large L-shaped sofa to port with storage below
- Sofa to starboard with storage below
- Coffee table
- 55" LED TV with storage unit
- Naim Uniti Star audio system with Focal 100 ICW6 speakers (4) and Focal Cub Evo subwoofer
- Panoramic tinted toughened glass windows port and starboard
- Access stairway to lower accommodation
- Access stairway to skylounge

- Storage cabinet adjacent to starboard guest lobby for 2 dining chairs
- Dimmable LED overhead/concealed lighting (24v) with scene selection
- 220/240v outlets (2)
- USB charging points (4) (2x USB-A and 2x USB-C)
- Electric sheer roller blinds to all outboard windows
- Fitted carpet to saloon and corridor area
- Onboard ethernet router and 4G/5G internet modem

#### Dining area

- Circular extending, electrically sliding dining table with dining chairs (8)
- Full height storage unit with crockery, glassware and general storage
- Fridge and icemaker
- Manual curved 3 pane (2 sliding, 1 fixed) stainless steel framed patio door
- Panoramic full height tinted toughened glass window to starboard

- Manual curtains on track to aft patio doors, stowed to port and starboard
- 220/240v power outlets (2)
- USB charging points (2) (1x USB-A and 1x USB-C)
- Dimmable LED overhead/concealed lighting (24v) with scene selection
- Fitted carpet

#### Galley

- Enclosed galley
- Granite/quartz counter top
- Miele induction hob
- Hob extractor
- Miele combination microwave/convection oven with grill
- Blanco Etagon 700-IF stainless steel sink with mixer tap and chopping board
- Twin SubZero full height refrigerators with deep freeze drawers
- Dishwasher (12 place)
- Waste bin (segmented for recycling)
- Drawers and storage cupboards
- Electric sheer roller blinds to window

- Hinging door to port side deck
- Dimmable LED overhead and task lighting (24v)
- 220/240v outlets (4)
- Timber-laid flooring (V-groove planked)
- Access to deck saloon lobby via hinged door
- Access to crew cabin via hinged door
- Floor hatch escape hatch from lower guest accommodation

#### Day head

- Electric freshwater toilet
- Wash basin and counter top in thermoformed Solid Surface
- Storage cupboard
- Manual tension venetian blind
- Marble/granite/quartz flooring

#### Accommodation

- All cabins and bathrooms feature opening portholes and air conditioning
- All cabins feature 220/240v power points

- All en-suites feature 240v shaver points

### **Owners stateroom**

- Large double bed with bedside tables and drawers below
- Walk in dressing area with full length mirror, hanging, shelf, drawer storage, and pocket door (to enclose dressing area)
- Escape hatch from crew cabin
- Built-in safe
- Starboard side dressing table with integrated mirror, chair, storage drawers and cupboards
- Sofa and storage to port side
- 55" LED TV on rise and fall mechanism, within sideboard unit
- Naim Uniti Atom audio system with Focal 100 ICW6 speakers (2)
- Panoramic windows including opening portholes
- Deck escape hatch to weatherdeck
- Electric roller blinds to outboard windows
- Manual sheer roller blind outboard of roller blind to all outboard windows
- Electric forward window blind

- Dimmable LED overhead/concealed lighting (24v) with scene selection
- 220/240v outlets (2)
- USB charging points (4) (2x USB-A and 2x USB-C)
- Fitted carpet (except steps to optional owner's private terrace access)

### **En-suite bathroom**

- Electric freshwater toilet in own compartment and option of combination toilet / bidet
- Shower compartment with automatic pump out (includes overhead rainfall shower and fully adjustable hand shower)
- Extractor fan
- Single wash basin and vanity top
- Mirror
- Storage lockers
- Medicine cabinet
- Heated towel rail
- Window with opening porthole
- Manual tension venetian blind
- LED overhead and concealed lighting (24v)

- Bathroom accessories
- Marble/granite/quartz flooring and specified bulkhead

### **Lower stateroom**

- Large double bed with bedside tables and drawers below
- Port and starboard side wardrobes
- Port side dressing table with integrated mirror, stool and storage drawers
- Starboard side L-shaped sofa
- 55" LED TV
- Naim Uniti Atom audio system with Focal 100 ICW6 speakers (2)
- Panoramic windows including opening portholes
- Electric roller blinds to hull windows
- Dimmable LED overhead/concealed lighting (24v) with scene selection
- 220/240v outlets (2)
- USB charging points (4) (2x USB-A and 2x USB-C)
- Fitted carpet

### **En-suite bathroom**

- Electric freshwater toilet

- Shower compartment with automatic pump out (includes overhead rainfall shower and fully adjustable hand shower)

- Extractor fan
- Wash basin and vanity top
- Mirror
- Storage lockers
- Window with opening porthole
- Manual tension venetian blind
- LED overhead and concealed lighting (24v)
- Bathroom accessories
- Marble/granite/quartz flooring

### **Starboard guest cabin**

- Double bed with drawers below
- Bedside tables
- Dressing table with stool
- Single wardrobe with shelves
- Mirror
- Storage lockers
- Window with opening portholes
- Electric roller blinds to hull windows

- Dimmable LED overhead/concealed lighting (24v) with scene selection
- Individual berth lights
- 220/240v outlets (1)
- USB charging point (2) (1x USB-A and 1x USB-C)
- Fitted carpet

#### En-suite bathroom

- Electric freshwater toilet
- Wash basin and vanity top
- Mirror
- Storage lockers
- Shower compartment with automatic pump out (includes overhead rainfall shower and fully adjustable hand shower)
- Extractor fan
- Window with opening porthole
- Manual tension venetian blind
- LED overhead and concealed lighting (24v)
- Bathroom accessories
- Marble/granite/quartz flooring

#### Port guest cabin

- Double bed with drawers below
- Bedside tables
- Dressing table with stool
- Large double wardrobe with shelves
- Mirror
- Storage lockers
- Window with opening portholes
- Electric roller blinds to hull windows
- Dimmable LED overhead/concealed lighting (24v) with scene selection
- Individual berth lights
- 220/240v outlets (1)
- USB charging point (2) (1x USB-A and 1x USB-C)
- Fitted carpet

#### En-suite bathroom

- Electric freshwater toilet
- Wash basin and vanity top
- Mirror
- Storage lockers

- Shower compartment with automatic pump out (includes overhead rainfall shower and fully adjustable hand shower)
- Extractor fan
- Windows with opening portholes
- Manual tension venetian blind
- LED overhead and concealed lighting (24v)
- Bathroom accessories
- Marble/granite/quartz flooring

#### Lower accommodation lobby

- Linen cupboard below companionway stairs
- LED overhead/concealed lighting (24v)
- Fitted carpet

#### Crew quarters

- All lower crew furniture is in white laminate, with Koko white Solid Surface (satin finish) bathroom vanity unit tops and Koko white Solid Surface (satin finish) bathroom floors

#### Forward starboard crew cabin

- Oversized single bed with storage below
- Wardrobe with shelf

- Mirror
- Storage lockers
- Opening porthole with manual venetian blind
- LED overhead lighting (24v)
- Individual berth light
- 220/240v outlets (1)
- USB charging points (2) (1x USB-A and 1x USB-C)
- Non-slip safety flooring

#### Aft starboard crew cabin

- Twin single bunk berths with storage below lower berth
- Wardrobe
- Mirror
- Storage locker
- Opening porthole with manual venetian blind
- LED overhead lighting (24v)
- Individual berth light
- 220/240v outlets (1)
- USB charging points (2) (1x USB-A and 1x USB-C)
- Non-slip safety flooring

- Emergency escape through headlining to Owner's Stateroom walk in wardrobe

#### **Crew bathroom**

- Electric freshwater toilet
- Wash basin with Koko white (satin finish) Solid Surface vanity top
- Mirror
- Storage lockers
- Shower compartment with automatic pump out and access hatch to storage locker
- Extractor fan
- Blind
- LED overhead lighting (24v)
- Bathroom accessories
- Solid Surface flooring in Koko white (satin finish)

#### **Crew mess area**

- Seating to port with folding table
- Galley area including fridge, microwave, sink with chopping board/mixer tap and storage with 220/240V outlets (2)
- Access from galley

- Combined 220/240v outlet (1) and USB charging points (2) (1x USB-A and 1x USB-C) located near port seating area

- Individual 220/240v outlet (1) and USB charging points (2) (1x USB-A and 1x USB-C) located in central storage tower

- LED overhead lighting (24v)

- Non-slip safety flooring

#### **Crew linen area**

- Access from crew mess area

- Washing machine and separate tumble dryer

- Storage

- 220/240v outlets (2)

- LED overhead lighting (24v)

- Non-slip safety flooring

#### **Power and drive systems**

- High volume air intakes

- Engine room extractor fans with electronic time delay

- Engine exhaust silencers and water-cooled exhausts

- Forward and aft engine room bulkheads and engine room deck head to be integrally bonded including insulation with acoustafoam layers

- Engines flexibly mounted

- Automatic and manual bilge pumps

- Propeller shafts

- 5-bladed propellers

- High speed balanced rudders

- Cathodic protection for stern gear

- Stern gear, engines, fuel tank fillers, all electrically bonded

- LED engine room lighting

- Engine room access from cockpit

- Power-assisted electro-hydraulic steering system (SeaStar)

- Electronic engine and gear shift controls

- Bow thruster with dual-station controls 550kgF

- Fresh water supply point in engine room

- Dripless self-aligning shaft seals

#### **Electrical systems**

24 Volt:

- 4 x heavy duty batteries for engine starting
- 6 x heavy duty auxiliary batteries
- 2 x heavy duty batteries for standard generators
- Battery link facility with remote control at helm position
- Both battery banks are charged using a voltage sensitive relay that parallels both battery banks when a charging source is present
- 1 x 100-amp charger, 1 x 100 amp - 3500W charger/inverter and 1 x 6-amp charger (for generator battery)
- Remote battery isolator control switches at main switch panel position
- Circuit breakers on all circuits
- 24v to 12v converters for certain navigation and radio circuits
- 24v to 240v/50Hz inverter for galley fridge
- Galvanic isolation system
- Princess Connect telemetry and maintenance system

220/240 Volt:

- European specification: Standard 2x 27kW Onan @50Hz diesel generators (with optional upgrade up to 2 x 35kW Kohler @ 50Hz diesel generators) in own sound shields, water cooled and with specially silenced exhaust systems and with remote operation from main control panel
- USA specification: Standard 2x 29kW Onan @ 60Hz diesel generators (with optional upgrade up to 2 x 40kW Kohler @ 60Hz diesel generators) in own sound shields, water cooled and with specially silenced exhaust systems and with remote operation from main control panel
- 220/240v shore power inlet (2x 63amp single phase)
- Shore power/generator change over control operated from main control panel
- Polarity check system
- Earth leakage safety trip, circuit breakers on all circuits
- Power points (240v) in all cabins and living areas, helm position and galley
- 240v shaver points in washrooms
- 4 x 2kW immersion heaters for fresh water (2 per calorifier)

#### **Fuel system**

- Total fuel capacity is 11,000 l

- Fuel polishing transfer system to day tanks with water and vacuum sensor alarms displayed on Böning screens
- Fuel fillers to port and starboard
- High capacity duplex fuel filters/water traps with integral changeover valves and water sensors connected to alarms at helm position
- Remote fuel isolation controls in cockpit locker for main engines and generators
- Fuel gauges at helm position, displayed on Böning screen with back up fuel gauges in the engine room

#### **Air conditioning system**

- Air conditioning/heating reverse cycle
- 291,000 BTU fan capacity with 216,000 BTU chiller capacity, suitable for temperatures to 40°C (tropical)
- Windscreen demist facility
- Outlets in all areas

#### **Water system**

- Fresh water tanks giving 1,500 l capacity plus 2x 150 l hot water calorifiers
- Automatic AC and DC electric water pump with filter (80 l/min)

- Water level gauge, displayed on Böning screen
- Deck filler
- Pump control at main helm station
- Electric freshwater toilet system linked to 600 l black water holding tank, content gauge and low noise electric overboard discharge, with macerator backup system as well as dockside discharge system

#### **Bilge pumps**

- Automatic/manual override electric bilge pumps in lazarette, engine room, forward accommodation and crew area bow compartment
- High capacity manual bilge system with suction points in the lazarette, engine room, forward accommodation and bow compartment
- Electric bilge pumps have controls and warning lights with audible alarm at helm position

#### **Extinguishers / fire control systems**

- Automatic engine room fire extinguisher system (with manual override) and warning system at helm position providing automatic shutdown of engines, generators and ventilation fans

- Automatic under helm fire extinguisher
- Hand operated fire extinguishers in skylounge, saloon, galley, all guest cabins, and crew quarters

#### **Other standard equipment**

- Ensign staff
- Fenders (8)
- Mooring warps (4)
- First aid kit
- Set of towels (8 large, 8 hand), (10 for optional 5 cabin layout)
- Quilted bed cover supplied to all cabins (except crew cabin)
- Complete set of Lucrezia crystal glassware (8 settings consisting of tumbler, highball, champagne and wine glasses) (10 settings for optional 5 cabin layout)
- Set of Sous Le Soleil crockery (8 settings consisting of plate, cake plate, dessert plate, bowl, cup and saucer) (10 settings for optional 5 cabin layout)
- Set of stainless-steel cutlery (8 settings of David Mellor "Paris" cutlery 7 pieces) (10 settings for optional 5 cabin layout)
- Tool kit

- Boat hook
- Owner's manual and engine manual
- Ship's document case
- Covers to exterior furniture to match layout selected (standard layout includes cockpit seating cover, cockpit table cover, skydeck table cover (includes zip in chair covers), skydeck wetbar cover (2), skydeck L-shaped sofa cover (2), skydeck coffee table covers (2), skydeck foredeck seating cover (2) and skydeck foredeck coffee table cover)
- Curtains, blinds or sunscreens to all windows and portholes (excludes helm and pantograph doors)
- Crew bathrooms to have Solid Surface floors and counter tops
- Non-slip safety flooring to crew cabins, crew mess, linen area and passageway
- All seating and furniture covers (where provided as standard) in Sunbrella/Weathermax

## Finishes

- Teak-laid decks to all external deck areas (including flybridge)
- Timber-laid flooring (V-groove planked) to galley, skylounge and wheelhouse
- Furniture in Rovere Oak in satin finish as standard. Silver Oak or Ash satin finish or Walnut satin or gloss finishes available as an option.
- Marble/granite/quartz in all bathroom suites in guest accommodation (including day head)
- Galley counter top in granite or quartz
- Choice of high-quality carpets and fabrics from extensive range

# Digital Brochure



View the full digital brochure here: <https://brochures.princessyachts.com/story/princess-x90-brochure-english/>

# Optional Upgrades

# Sea Ready

With Sea Ready, we're redefining what effortless ownership looks like so you can spend more time exploring, relaxing and enjoying the water, and far less time preparing for it.

Whether you're a first-time owner or already a long-time member of the Princess family, Sea Ready brings together all the essentials you need before heading out to sea, thoughtfully curated in one convenient place.

You can now choose from a complete range of safety gear, navigation and communication tools, tender options and premium water toys – all selected by Princess experts. The goal is simple: to give you greater confidence, convenience, and peace of mind from the moment you step aboard.

Sea Ready options include:

- Safety equipment
- Tender and fittings  
[Explore the William Jet tender options using their online configurator →](#)
- Starlink communications set up
- Spare parts for key systems including drives, generators and water makers
- Watertoys
- Essential on-board equipment
- Boat name and port of registry



# Signature by Princess

Signature by Princess is a premium design service for owners who want their yacht to be unmistakably their own.

Signature offers a seamless, end-to-end experience - supporting you from your first spark of inspiration through to final execution. Whether you're seeking subtle refinements or a fully bespoke interior, our expert team works closely with you to bring your vision to life.

From tailored layouts and one-off design details to custom features such as private gyms, saunas or cinema suites, Signature transforms your ideas into beautifully considered realities. Through Signature, every yacht becomes a reflection of its owner - considered, distinctive and unmistakably personal.



SIGNATURE

BY PRINCESS

# Residence Collection

The Residence collection is designed to elevate the onboard living experience and comfort on your yacht.

Options include:

- Upgraded custom mattress from ViSpring
- Premium bed linens and towels packages from Heirlooms or Peter Reed
- Cockpit seating premium textile upholstery upgrade
- Platinum leather upgrade to key furnishings



# For Further Information

Please contact your Princess representative.

To find your Princess representative visit [princessyachts.com](http://princessyachts.com).



## Disclaimers

The details contained in this document were correct at the time of publication. Princess Yachts Limited reserves the right to modify or change the specification at any time without notice or liability. Craft illustrated in this brochure may be fitted with certain optional equipment.

PYL displacements are calculated with 50% fuel and water with life raft but with no optional equipment fitted or other gear.

<sup>†</sup> Maximum speeds will vary depending on cleanliness of hull, condition of sterngear, loading of craft, water and air temperatures, sea conditions, and other factors. Speed estimates are therefore given in good faith but without warranty or liability on the part of Princess Yachts Limited.