



CHEOY LEE – NOAM 2000 | € 1,900,000<sub>EX VAT</sub>





---

The Yacht

---





---

The Yacht

---





---

The Yacht

---





---

The Yacht

---



---

The Yacht

---





---

The Yacht

---





---

The Yacht

---





---

The Yacht

---





---

The Yacht

---





---

The Yacht

---





---

The Yacht

---





---

Saloon

---





---

Galley

---





---

The Yacht

---





---

Master Cabin

---



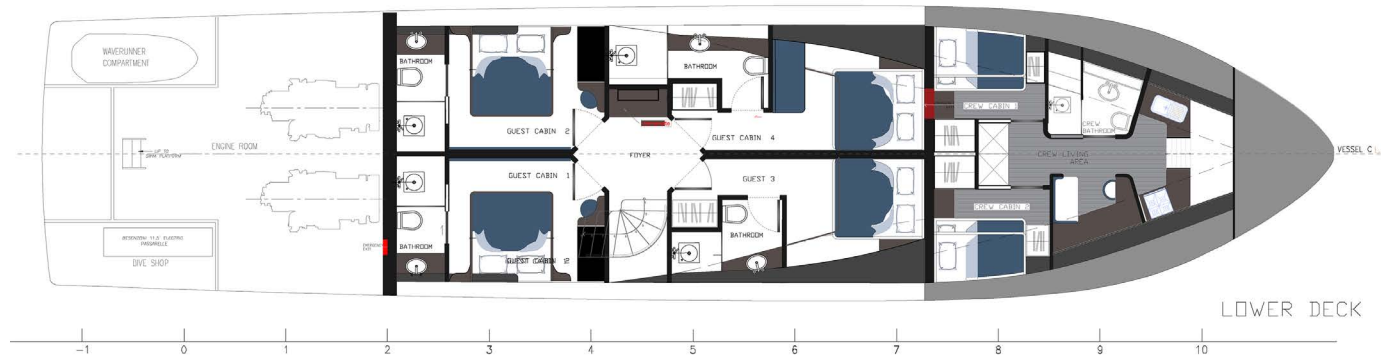
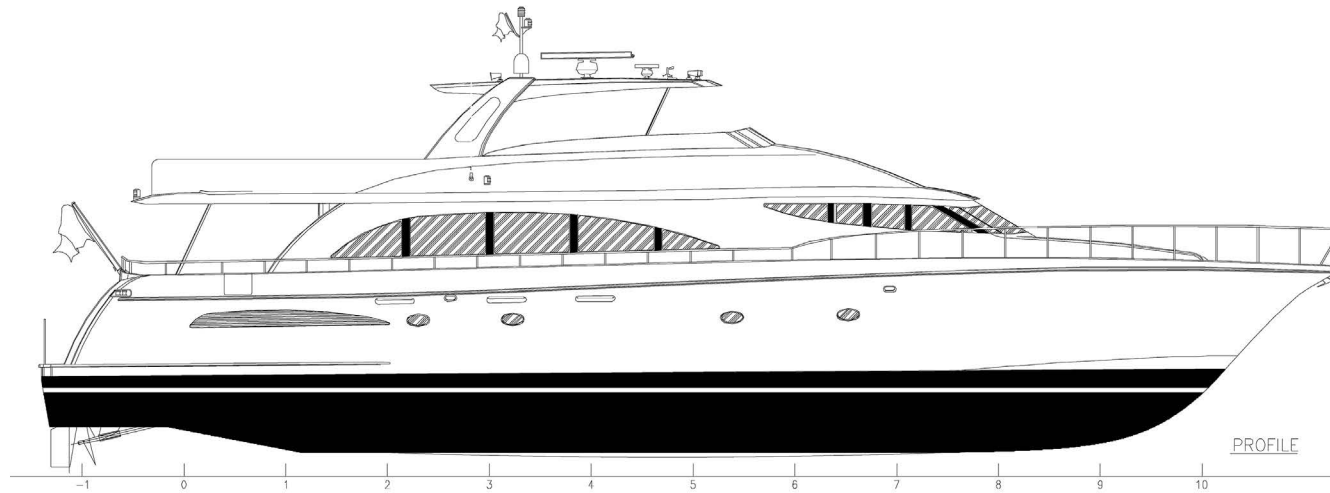



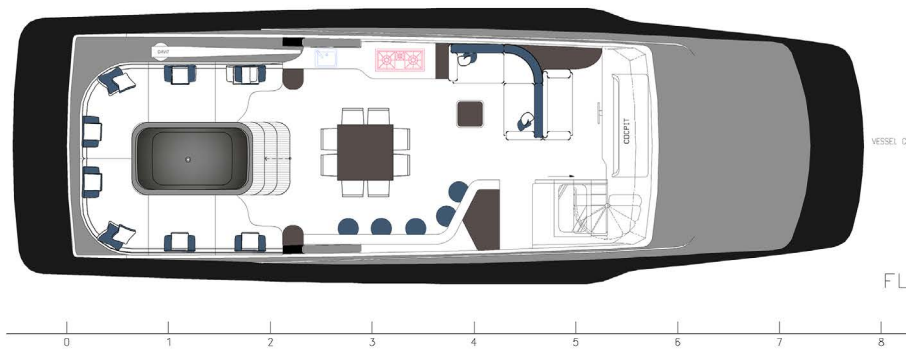
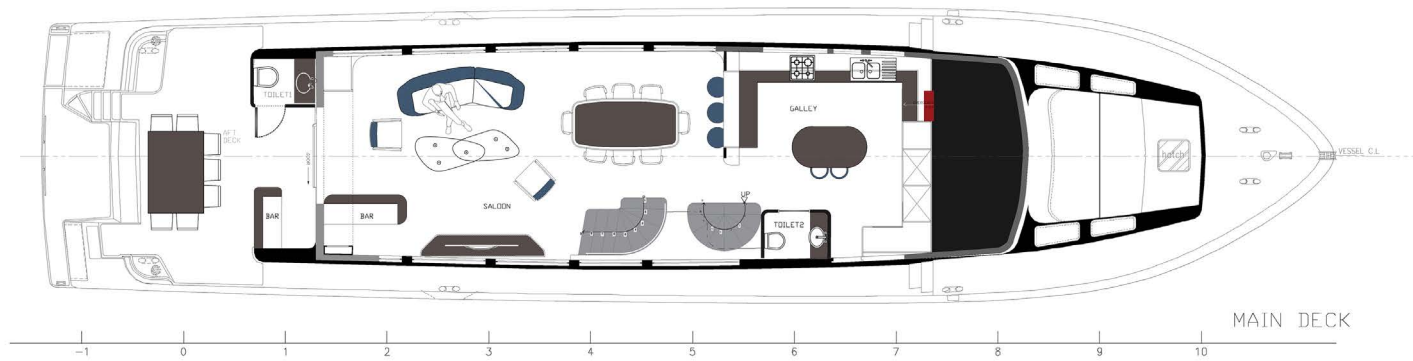

Scale 1/50

QUEEN KARINA  
28 METER  
GENERAL ARRANGEMENT PLAN



## MAIN FEATURES

- Modern technology meets classic design
- Top quality materials in traditional interior design
- Major refit works between 2020-2021

## HULL & DIMENSIONS

- Type: Motor Yacht
- Hull: Fiberglass
- Builder: Choe Lee Taiwan
- Model Year: 2000
- Last Ref it: 2020
- L.O. A: 30 m / 100 ft
- Beam: 6.5 m / 21.5 ft
- Draft: 2.5 m / 8.5 ft
- Displacement: 100 Tons
- Cruising Speed: 10 Knots
- Max speed: 20 Knots
- Flag: Delaware

## ENGINE ROOM

- 2x caterpillar 143-3522 Engine - Hours
- Port 1266
- STB 1263
- 1 x cummins onan -50K W 220v Generators
- 3284 hours
- 1 x cummins onan 27K W 220v Generator
- Hours - 2585
- Aqua Whisper Water Maker
- 1454.7 hours
- Clima Air-condition Unit 150.000BTU
- Miele Washing Machine and Miele Tumble Dryer
- 2 fresh water pumps
- Engine black water jet vacuum WC system
- Air compressor
- 1 hot water boiler 300lts
- 1 Crew cabin hot water boiler



## **DECK**

- 1x Fire Hose Points
- 1X Anchor Hydraulic Windless with 180mt chain and 250kg anchor
- Stainless steel and Teak swimming Platform/Ladder aft side - 1 x Aft deck table for 6 -8 pax
- 2x Harken Deck Winches
- Various fenders and Covers
- 5x Sun Umbrella
- Hot and cold-water Jacuzzi on flybridge

## **GALLEY**

- 1x Frankie Microwave
- 2x Frankie Convection /Fan Ovens
- 1x Bosch dishwasher
- 1x Frankie 2 door Fridge /Freezer
- 4x silver line Mini fridge at the bar/saloon
- Blender
- Coffee Maker
- Various normal kitchen appliances such as blender



## **NAVIGATION**

- 1x SIMRAD 18 inch with Radar & chart plotter. - 2020
- Autohelm Series Wind Indicator, speed, Depth and Auto Pilot. -2020
- VHF DSC 6222 -2020
- Furuno BNWAS BR 510 - 2019
- Side Power Hydraulic Bow thruster
- 2x IT T Jabsco Searchlight Controls
- 2x caterpillar Engine alarm control panel
- gen's indicators & remote control

## **TENDER**

- Tender: Monterey 8.2 LT mag 430 hp

## **CABINS**

- 4x Master Cabin with Shower and WC
- Access to crew quarters can be from the Bow of the Yacht for owners Privacy



## **SAFETY**

- Full Fire Extinguisher Safety Certificate
- 12 Fire extinguishers
- Protec Fire Alarm Control Panel Covering Whole Yacht
- Full Complement of Flares as per SOL AS
- 2x 8 men Life Rafts
- Life Jackets and Safety Harnesses
- EPIRBS: Kannad 406 MHz EPIRB

## **TANKAGE**

- Total Capacity Fresh Water 5000 liters
- Total Capacity Fuel 11,500 liters
- Grey and Black Total Capacity 5000 liters -Water Maker 1: Sea Recovery 500 LPH

## **ENTERTAINMENT SYSTEMS**

- Master Cabins: Sonos air play sound system
- Main Salon: Sonos air play sound system
- Main deck: Sonos air play sound systems
- Guest cabin Sonos air play sound system



**DECK TOYS**

- 2x 1 Man Kayaks
- 1x Sea Bike
- 1x Diving Equipment
- 1x sea bob



**DISCLAIMER**

All speeds, measurements, capacities, consumptions, etc. may be approximate or estimated. Specifications provided for information only. Data was obtained from sources believed to be reliable and is not guaranteed by owner or brokers. Buyer assumes the responsibility to ascertain the correctness of all data contained herein and otherwise provided and must instruct his agent and surveyors to confirm all details for accuracy prior to purchase. Subject to prior sale, price and inventory change, or withdrawal from market without notice.



1 yordey yam st. marina Herzliya, Israel 46764 | Tel. 972-9-9513248  
Fax. 972-9-9513247 | [info@aquamarina.co.il](mailto:info@aquamarina.co.il) | [www.aquamarina.co.il](http://www.aquamarina.co.il)