

PRINCESS Y85 MOTOR YACHT  
PRODUCT PLATFORM DOCUMENT





# CONTENTS

PRINCESS Y85 MOTOR YACHT

---

Introduction	3
Exterior Design	4
Interior Design	11
Layouts	18
Technical Information	27
Main Competitors	29
Specification	30
Option Form	36
Advanced Information Pack	37





PRINCESS Y75 MOTOR YACHT

## INTRODUCTION

The all-new Y85 Motor Yacht is a yacht with an imposing presence, her sleek profile reflects the latest thinking in Motor Yacht design whilst retaining the elegance of her smaller counterparts. This new model resets the benchmark for exterior Motor Yacht refinement, with luxurious finishes and materials used in abundance to elevate the motor yacht cruising experience.

The flybridge is designed for entertaining al fresco with a large dining area opposite a well-equipped wet bar, further complimented by a large aft sunpad and forward facing seating areas either side of the helm position. Forward on the main deck is an impressive walkthrough seating area with additional sunpad.

The sociable arrangement of the single-level main deck provides an expansive entertaining space with three separate seating areas including a large cockpit dining area, ample U-shaped seating area aft of the saloon and formal dining area adjacent to the well-equipped galley.

The layout is designed to ensure the upmost privacy for guests with a separate wheelhouse and ability for the crew to move discreetly around the yacht, with the flexibility to open the galley to the aft saloon or separate it using an elegant electrically operated divider. Below deck guests are accommodated across four beautifully appointed ensuite cabins including a full beam master suite, two double cabins and one twin. Aft she features class leading crew quarters with two cabins and a spacious crew mess.



## EXTERIOR DESIGN





# PROFILE



WHITE HULL WITH HARDTOP



## EXTERIOR





## EXTERIOR COCKPIT





## EXTERIOR FOREDECK





# EXTERIOR FLYBRIDGE





## EXTERIOR FLYBRIDGE





# INTERIOR DESIGN

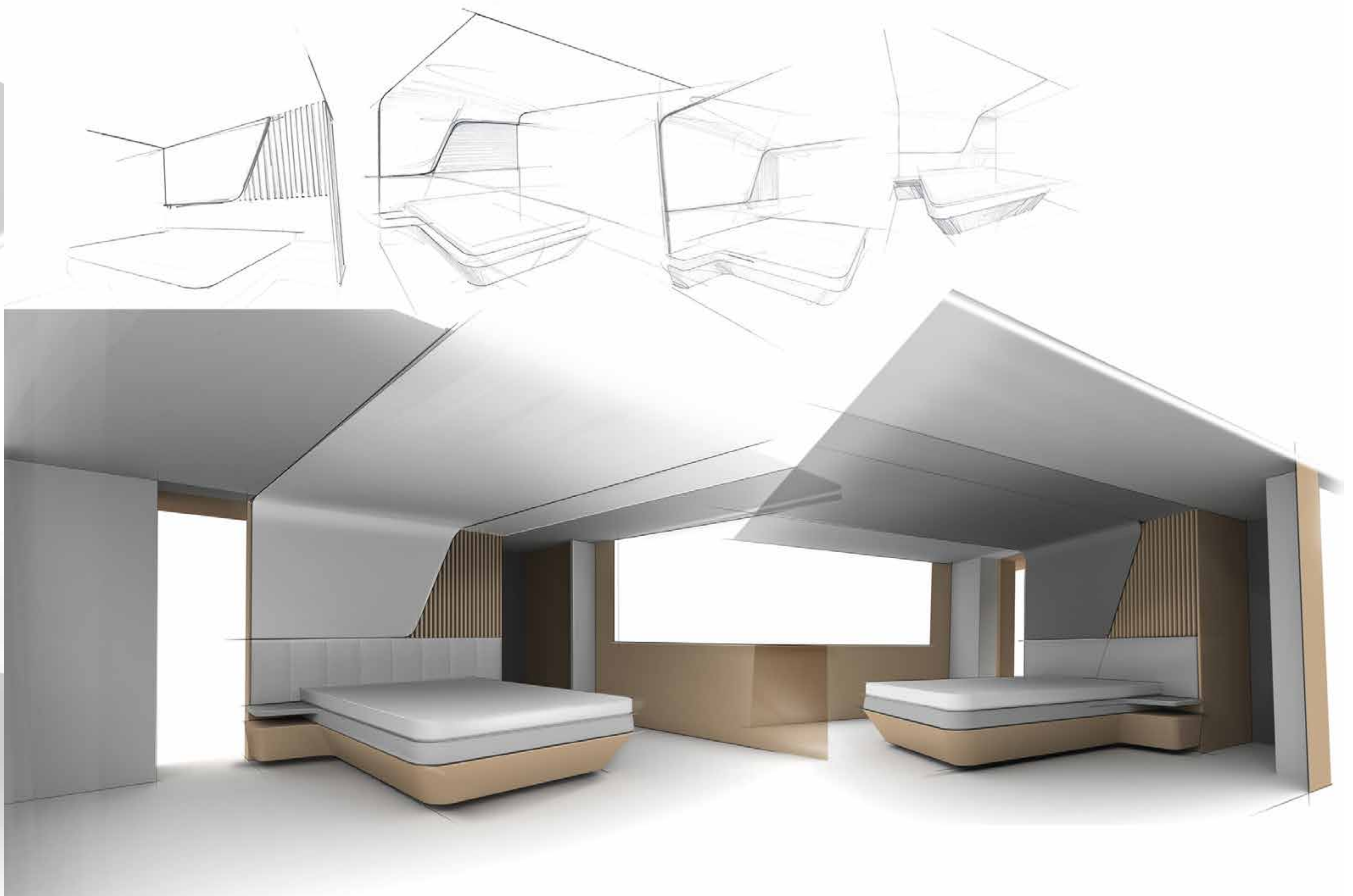
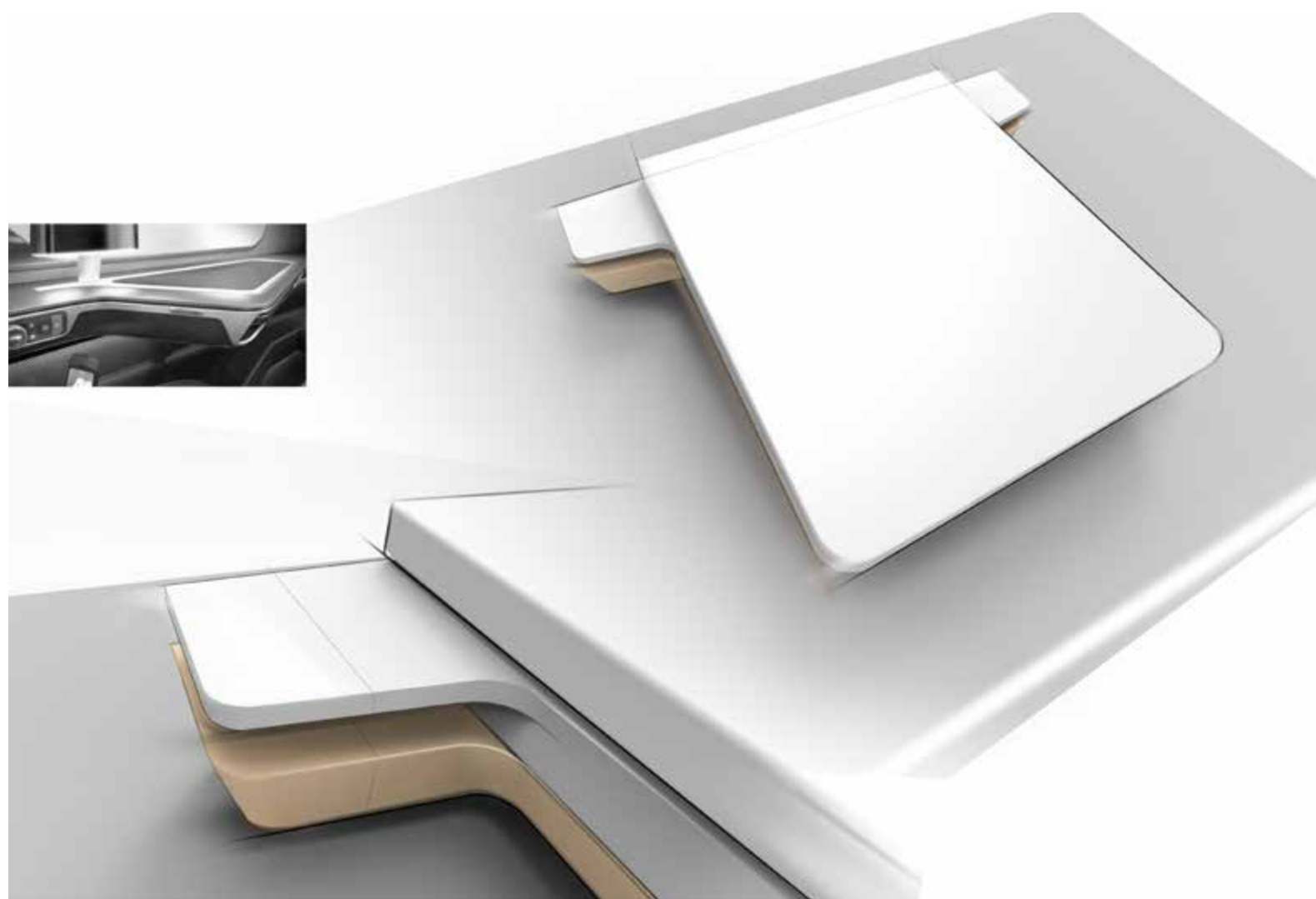



# INTERIOR SALOON



Image showing Silver Oak timber option



# INTERIOR SALOON



Image showing Walnut Satin timber option



# INTERIOR STATEROOM



Image showing Silver Oak timber option



# INTERIOR STATEROOM



Image showing Walnut Satin timber option



INTERIOR  
DINING AREA





# INTERIOR GALLEY





# LAYOUTS

Highlights of the Princess Y85 Motor Yacht:

- Expansive main deck layout with flexible galley arrangement for open family boating or closed for more formal occasions with full crew
- Beautifully appointed master stateroom with athwartship bathroom incorporating large stall shower (and optional bath) and separate toilet compartment
- Separate enclosed wheelhouse
- Crew quarters with crew mess, captain's cabin, bunk cabin and bathroom with separate stall shower
- Main deck day head
- Side access doors to side decks from helm and galley areas
- Teak-laid flybridge, deck areas and bathing platform
- Wide side decks and high bulwarks
- Foredeck seating and sunbathing area with adjustable headrests (convertible to aft facing U-shaped seating area)
- High quality finish including granite-quartz flooring in all guest bathrooms



FLYBRIDGE



MAIN DECK



LOWER DECK



FLYBRIDGE LAYOUT

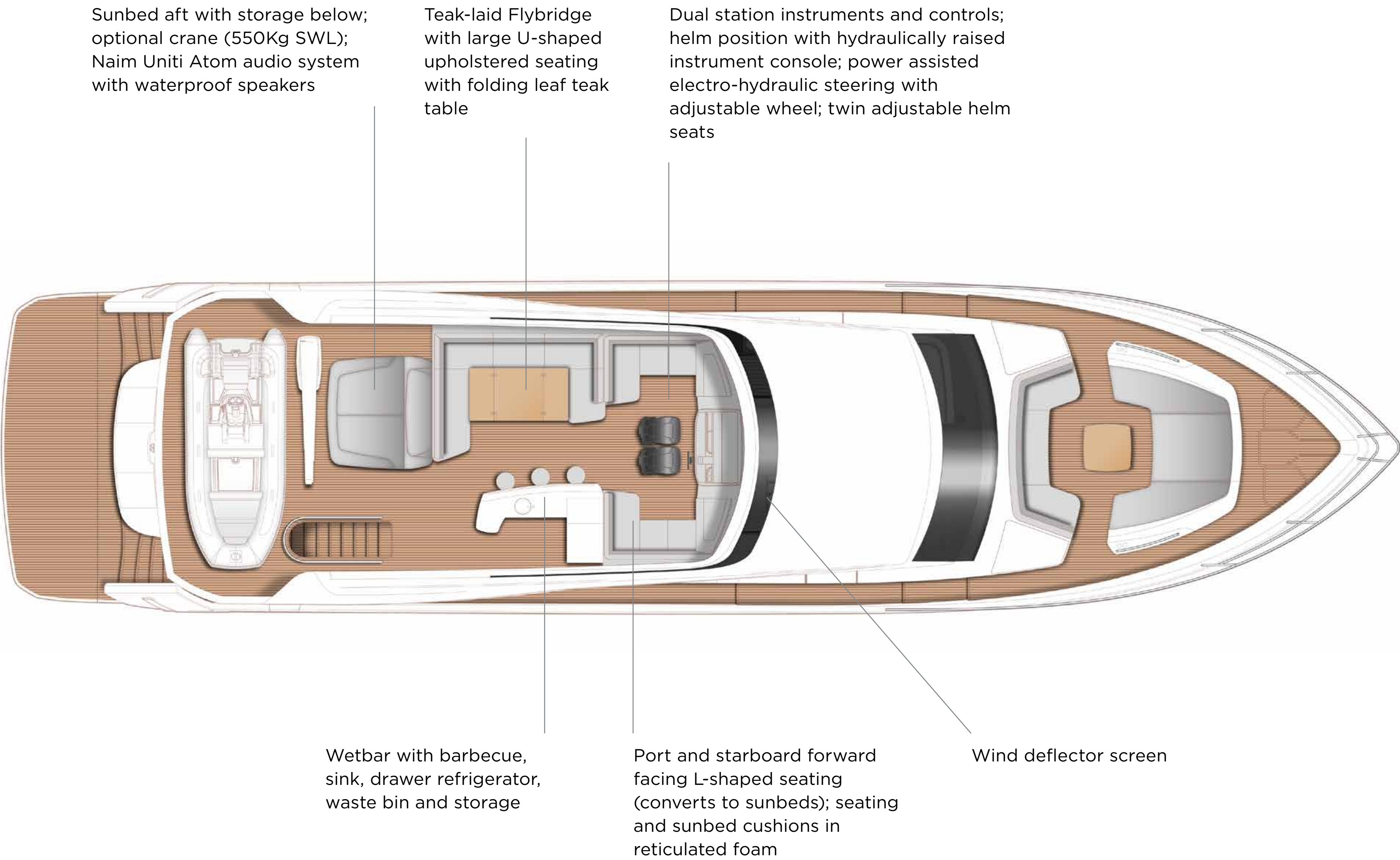



MAIN DECK LAYOUT

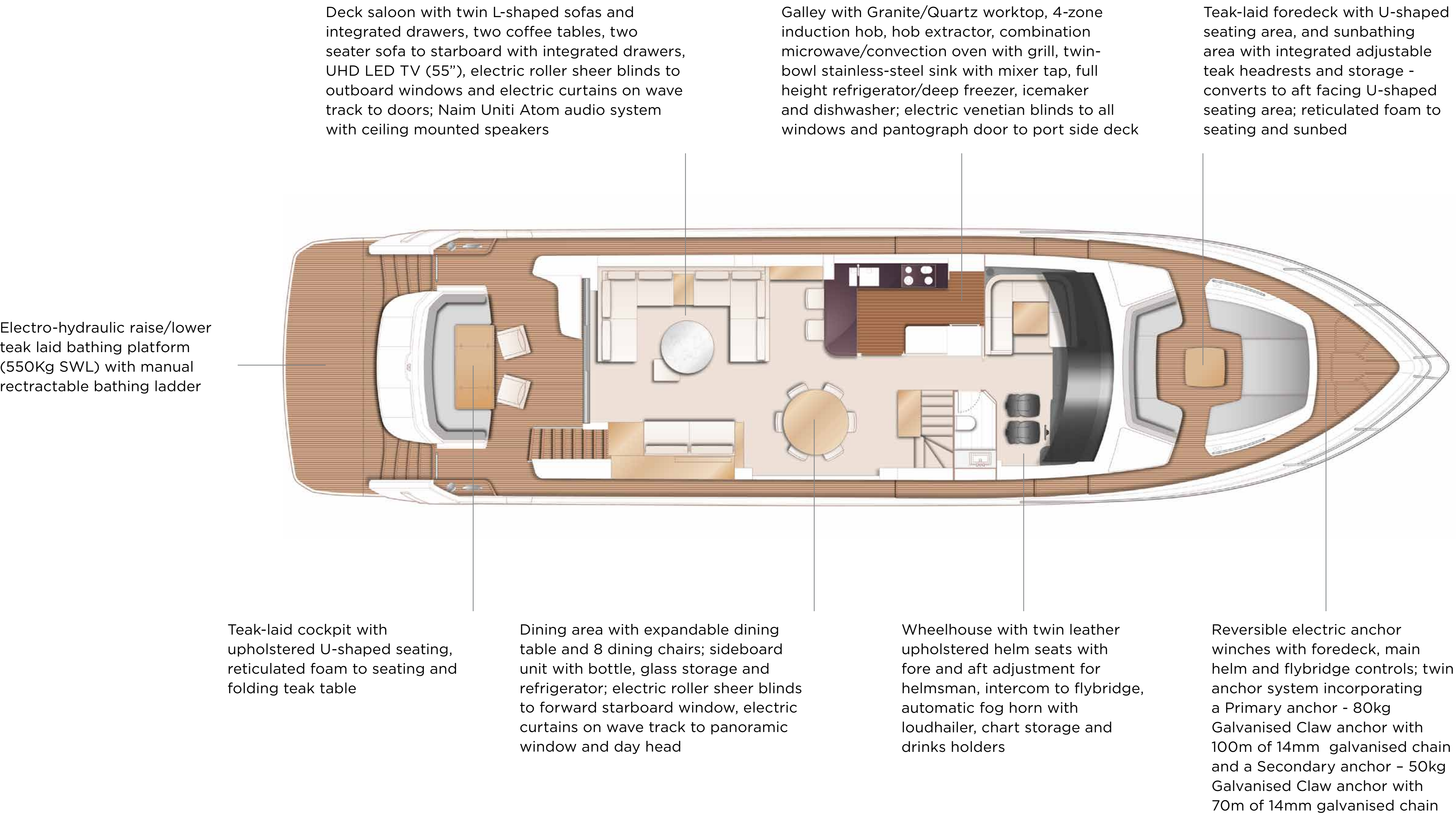



LOWER DECK LAYOUT

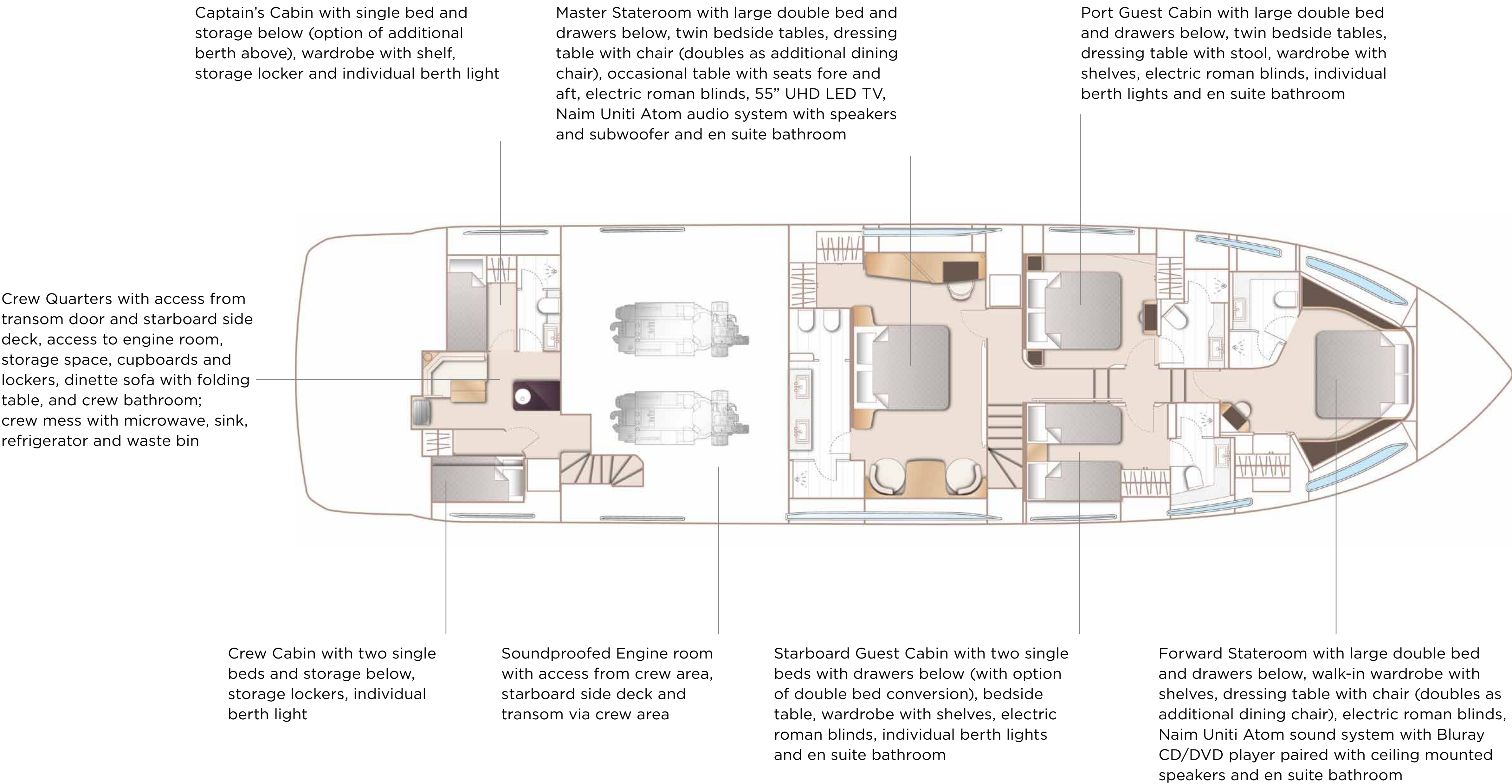



SQUARE METREAGE  
FLYBRIDGE

Flybridge 50.4m²





SQUARE METREAGE  
MAIN DECK

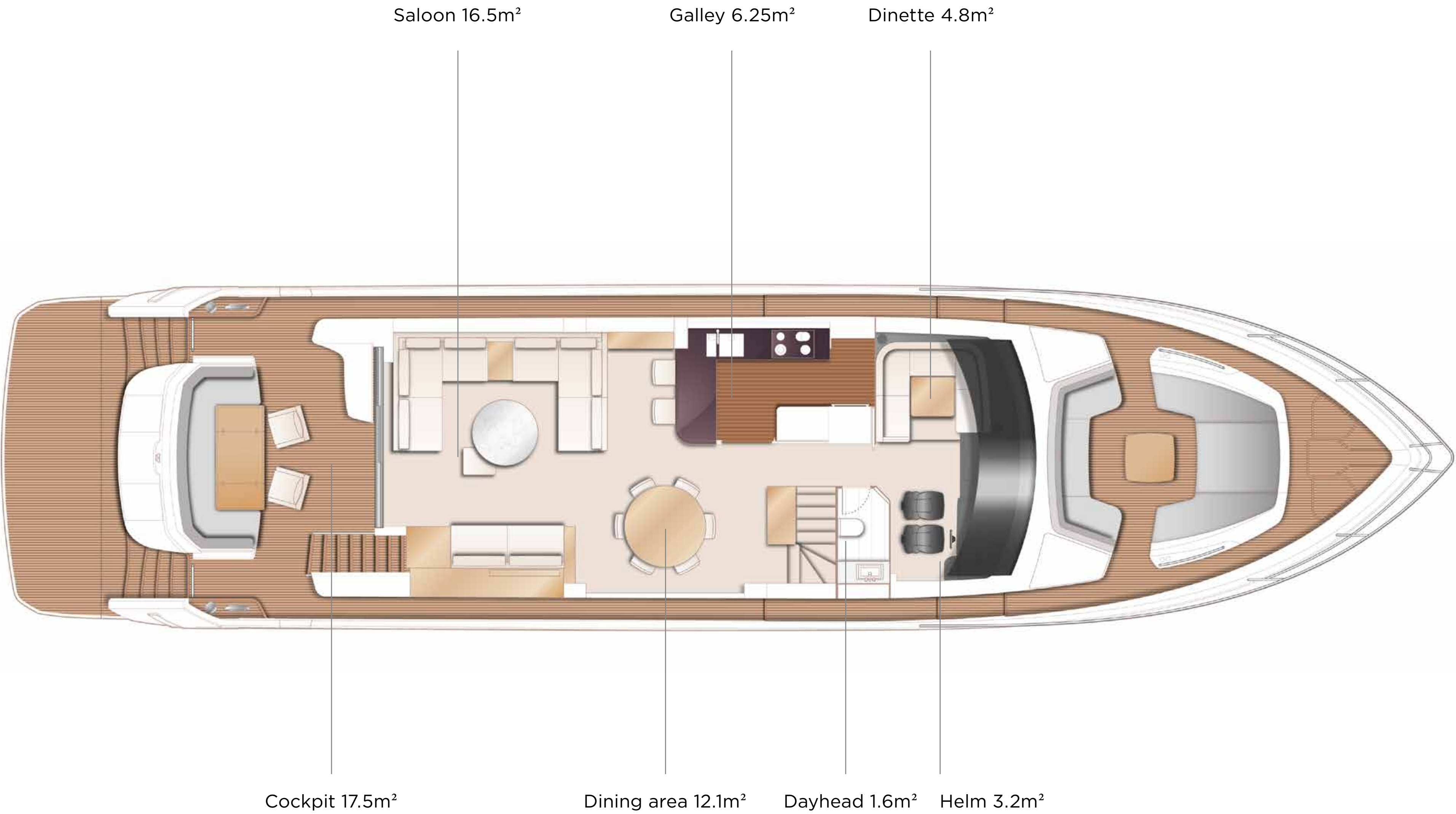



SQUARE METREAGE  
LOWER DECK

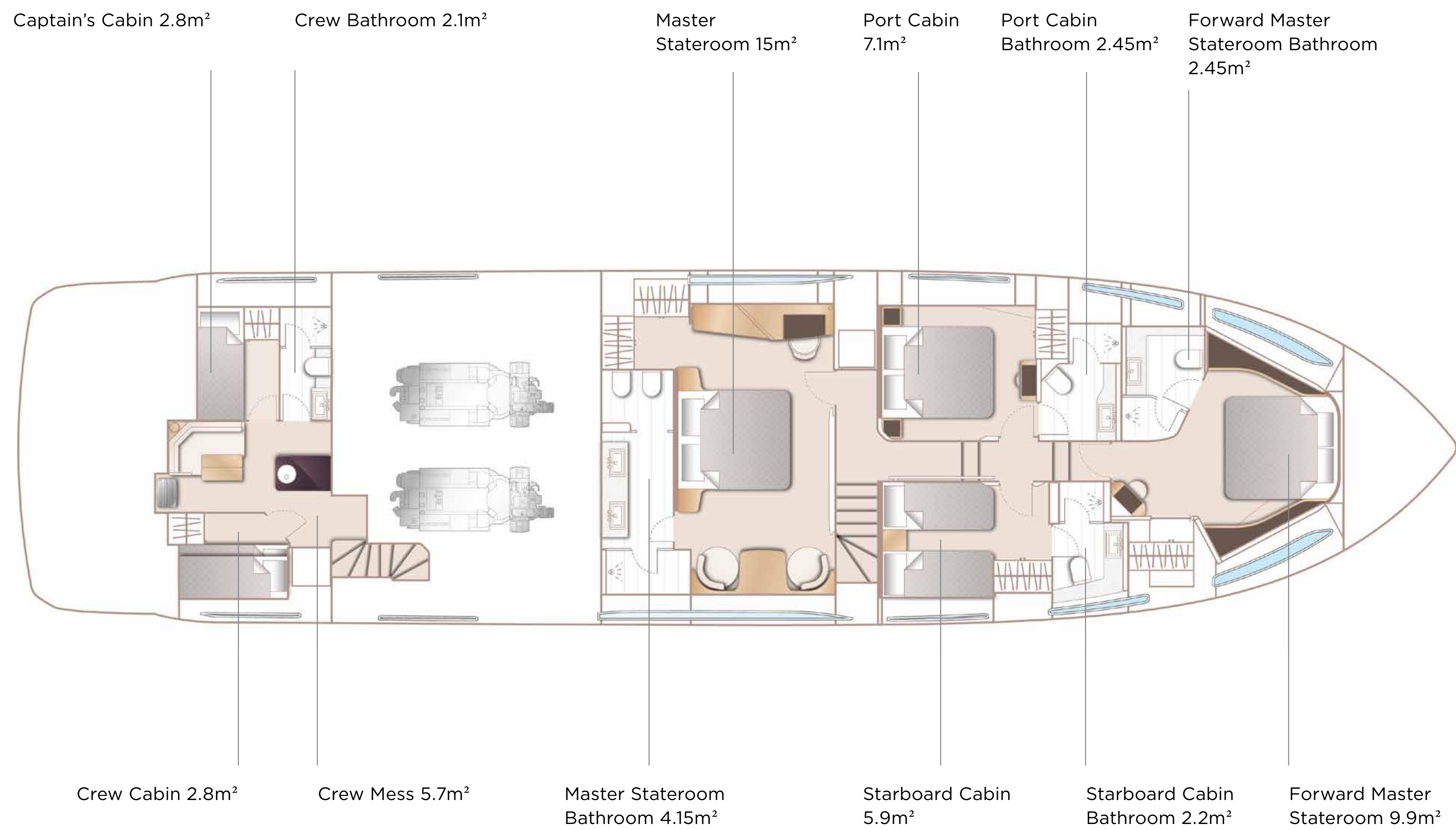



# BED DIMENSIONS

All beds in main guest cabin areas feature bespoke Vispring mattresses.

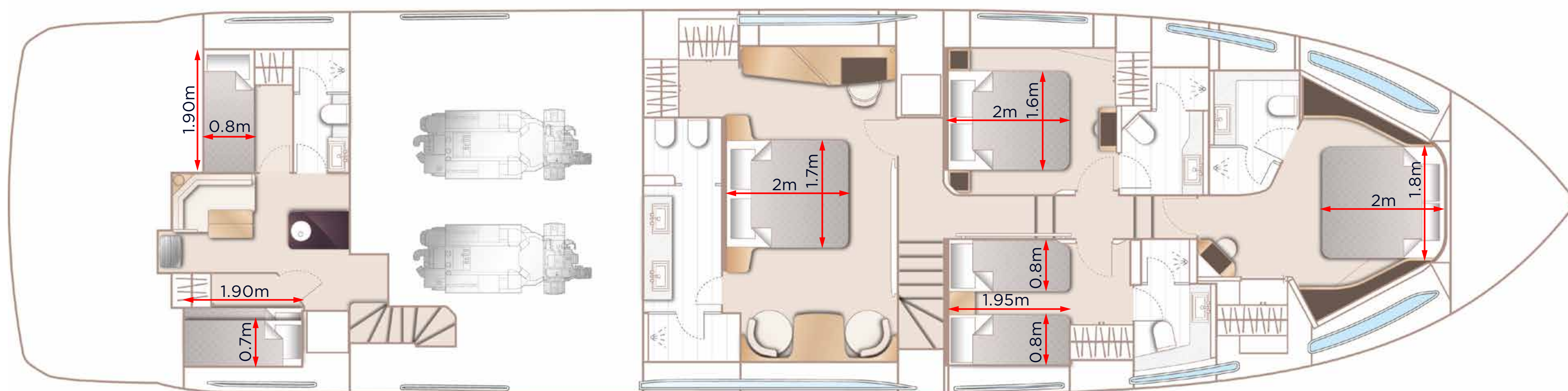



# HEADROOM

Princess design is renowned for its use of space and light and the Princess Y85 Motor Yacht is no exception, the design team have maximised the internal space available to ensure the customers onboard experience is the best it can be both aesthetically and practically.

The following diagram illustrates headroom allowance in all key areas of the Princess Y85 Motor Yacht.

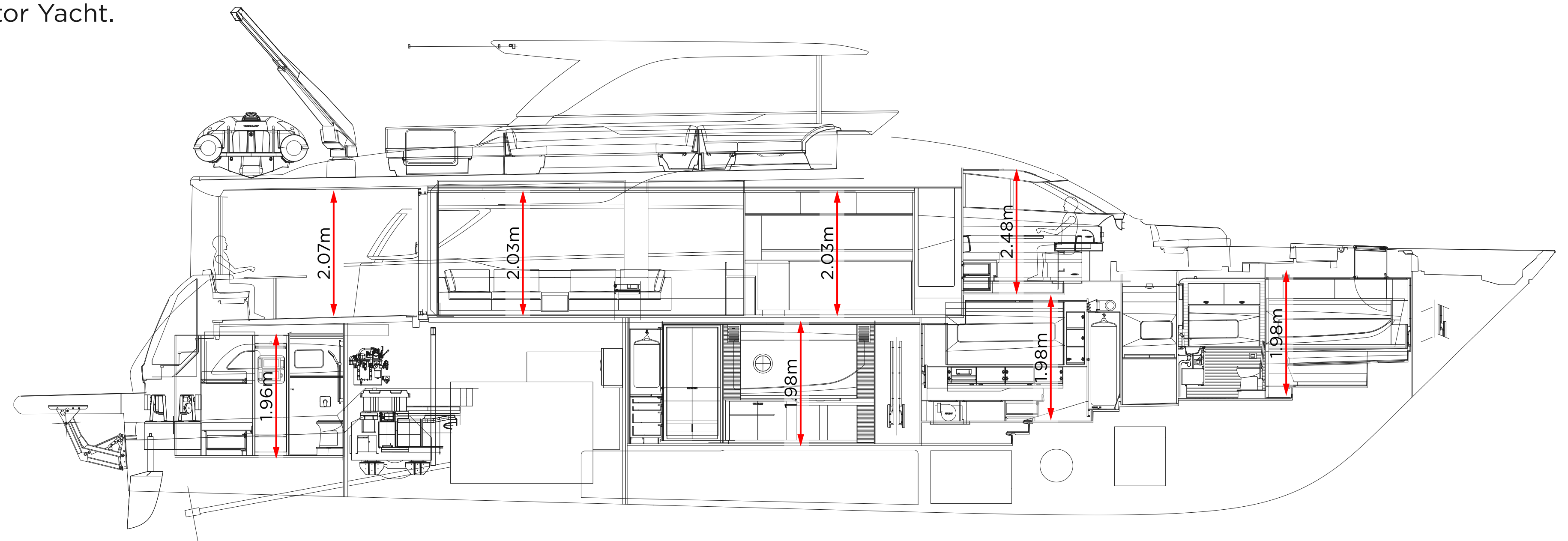



# TECHNICAL INFORMATION

## BATHING PLATFORM AND TENDER

The optional electro hydraulic transom platform has a 550kg safe working load capacity, it is fitted as standard and can accommodate a tender with a maximum weight of 550kg, like the Williams TurboJet 445 or the Williams SportJet 435.

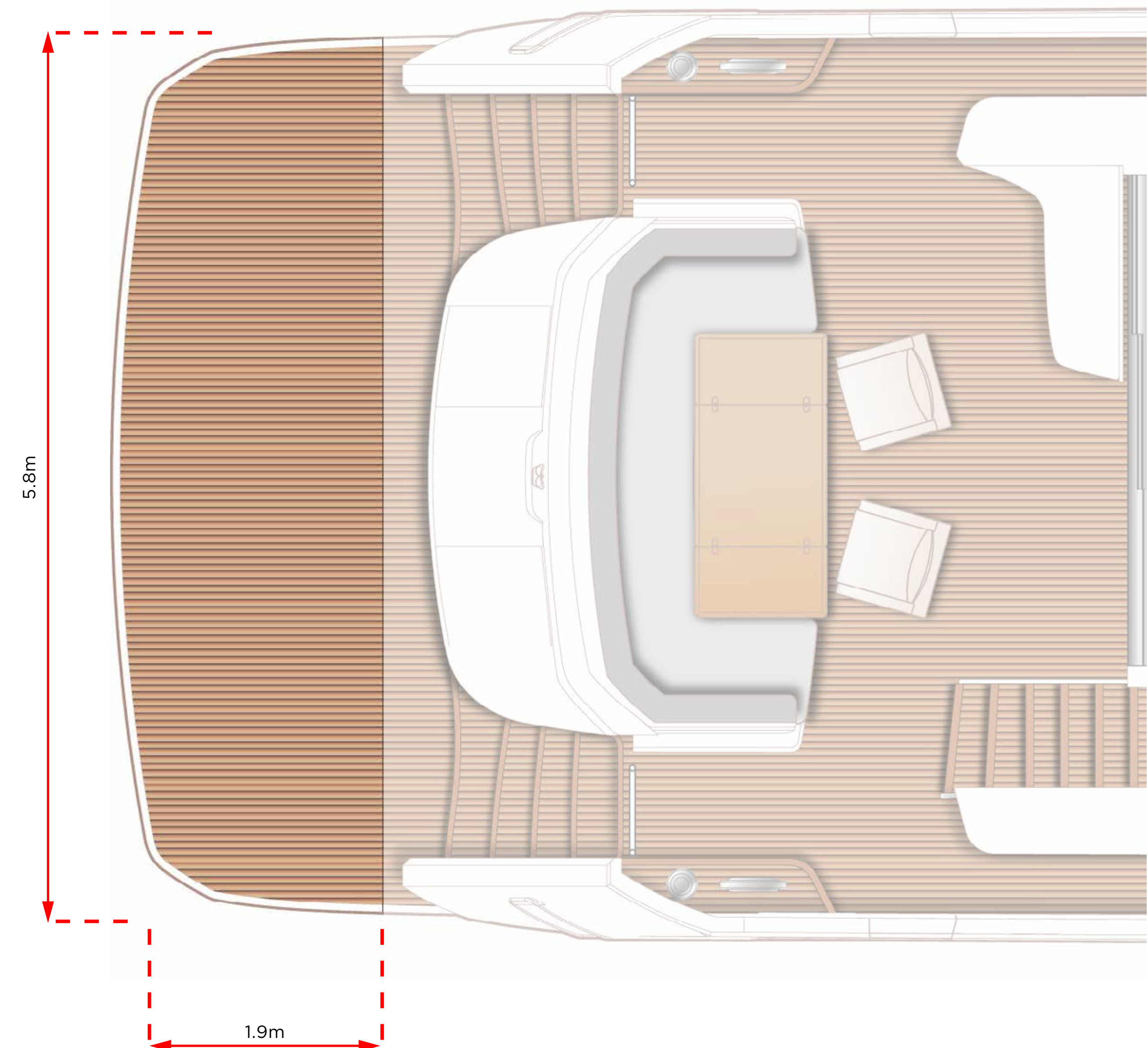



# PASSARELLE

The remote control telescopic passarelle is designed for use by one person only, effective safe working load of 150kg.

It must only be used for embarkation and disembarkation. Never use the passarelle for any other activity.

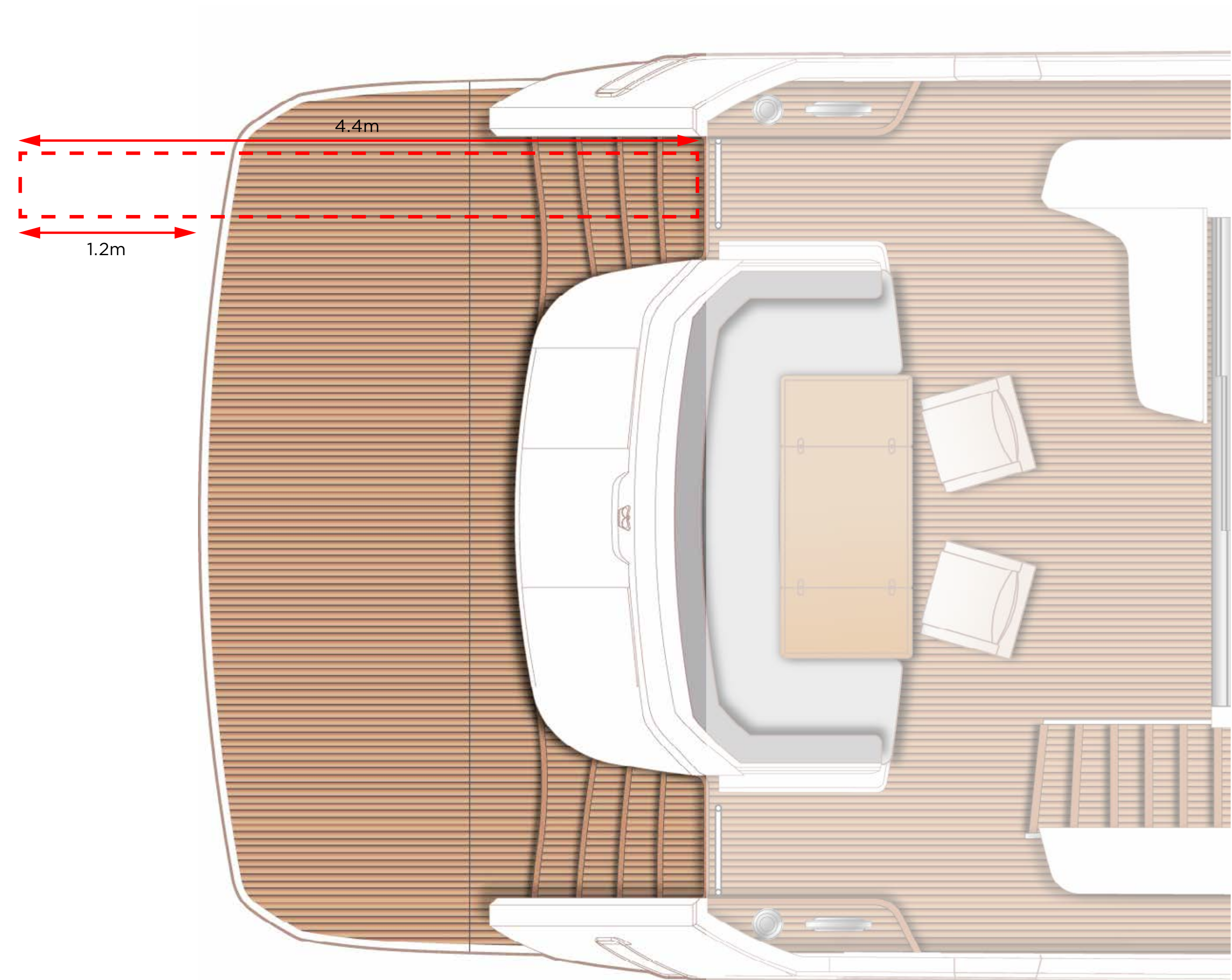



## MAIN COMPETITORS

	Princess Y85 Motor Yacht	Ferretti 850	Azimut 80	Sunseeker 86	San Lorenzo 86	MCY 86
						
<b>LOA</b>	84'6" / 25.75m	85'3" / 26.0m	82'8" / 25.2m	86'3" / 26.3m	87'8" / 26.76m	86' / 26.3m
<b>Beam</b>	20'8" / 6.3m	20'7" / 6.28m	20'3" / 6.18m	21' 3" / 6.47m	20'8" / 6.35m	21'2" / 6.46m
<b>Draft</b>	5'9" / 1.77m	6'6" / 2.0m	5' 8" / 1.72m	6'5" / 1.95m	6'3" / 1.9m	6' 3" / 1.9m
<b>Displacement (kg)</b>	66,500	↓ 77,490	↑ 64,000	↓ 67,000	↓ 82,000	↓ 72,000 (light)
<b>Fuel (L)</b>	11,000	↓ 6,750	↓ 6,000	11,000	↓ 8,400	↓ 7,100
<b>Fresh Water (L)</b>	1500	↓ 1320	↓ 1100	↓ 1400	↑ 1700	1500
<b>Engine</b>	MAN V12 1800	MAN V12 1800	MAN V12 1550	MTU 12V 1924	MTU 10V 1622	MAN V12 1800
<b>Maximum Speed (kn)</b>	↑ 32	↓ 29	↓ 28	↓ 30	↓ 28	↓ 29
<b>Number of Cabins</b>	4	4	4	4	4	↑ 3-5
<b>Number of Heads</b>	5	5	5	5	5	5



# SPECIFICATION

## PRINCIPAL DIMENSIONS

Length overall (Incl. pulpit)	84' 6"	25.75m
Length overall (excl. pulpit)	86'0"	26.2m
Beam	20'8"	6.3m
Draft (at full load) approx	5'9.5"	1.77m
Displacement approx (lightship)	60.7 tonnes	
Displacement approx (halfload)	66.5 tonnes	
Fuel capacity	11000 litres / 2420 gal / 2905 USG	
Water capacity (excl. calorifier)	1295 litres / 285 gal / 342 USG	
Hot Water calorifiers	205 litres/ 45 gallon / 54 USG	
Black water tank	600 litres / 132 gal / 158 USG	

## ENGINES - DIESEL

MAN V12 (2 x 1800mhp)	Maximum speed - up to 30 - 32 knots <sup>†</sup>
MAN V12 (2 x 1900mhp)	Maximum speed - up to 31 - 33 knots <sup>†</sup>

<sup>†</sup> Speeds are given at half load condition with boat to standard specification and with no additional equipment on board. Speeds are estimated and given in good faith but without warranty.



DETAILED SPECIFICATION

DECK FITTINGS

- Teak-laid transom platform, cockpit deck, flybridge, flybridge stairway, side decks and foredeck walkthrough
- Reversible hydraulic anchor winches with foredeck, main helm and flybridge controls
- Stemhead roller with automatic anchor launch and retrieve
- Twin anchor system incorporating a Primary anchor - 80kg Galvanised Claw anchor with 100m of 14mm galvanised chain and a Secondary anchor – 50kg Galvanised Claw anchor with 70m of 14mm galvanised chain.
- Twin electric sternline mooring winches
- Deck hatch access to chain locker
- Bow rope stowage locker
- Freshwater deck/anchor wash (with both fore and aft deck outlets)
- Stainless steel bow and stern fairleads
- Stainless-steel bow, stern and spring cleats (2 pairs)
- Stainless-steel pulpit and guard rails with teak capping to side deck sections
- Stainless steel coachroof and flybridge handrails
- Foredeck escape hatch
- Foredeck U-shaped seating area
- Foredeck sunbathing area with integrated adjustable teak headrests and storage, converts to aft facing u-shaped seating area
- Reticulated foam to seating and sunbed
- Twin coachroof lockers for storage of fenders, ropes and cushions
- PVC rubbing band with stainless-steel insert

- LED deck level lighting
- Full set of IMCO navigation lights
- Riding light
- Twin beam searchlight with dual station remote controls
- Loudhailer
- Stern docking lights
- Twin electric horns
- Fuel and water fillers
- Telephone connection point

AFT COCKPIT AND BATHING PLATFORM

- Self-draining
- Upholstered U-shaped seating
- Reticulated foam to seating
- Folding teak table
- LED overhead and deck level lighting
- Stainless-steel handrails
- Remote control 4.4m telescopic passarelle with folding handrails
- Watertight pantograph doors giving direct access from starboard side deck and transom to crew cabin /engine room
- Rope storage lockers
- Locker containing remote fuel cocks, manual bilge pump with valve chest and manual controls for automatic fire extinguishers
- Integral stairway to flybridge with teak step treads
- Twin transom gates leading to bathing platform
- Electro-hydraulic raise/lower teak laid bathing platform (550kg SWL)
- Retractable bathing ladder (manual) in side of hydraulic platform

- Transom access to lazarette
- Transom steps to access stern from bathing platform when in lowered position
- Dinghy chock system
- Hot and cold transom shower
- 220/240v shore support inlets
- Cockpit cover

FLYBRIDGE

- Dual station instruments and controls (see Lower Helm Position)
- Helm position with hydraulically raised instrument console
- Power assisted electro-hydraulic steering with adjustable wheel
- Audible and visual alarm for bilge pumps
- Engine room fire extinguisher warning system
- Twin adjustable helm seats
- Port and starboard forward facing L shaped seating (converts to sunbeds)
- Large U-shaped upholstered seating
- Reticulated foam to all fixed seating and sunbeds
- Folding leaf teak table
- Wetbar with barbecue, sink, drawer refrigerator, waste bin and storage
- Sunbed aft with storage below
- Naim Uniti Atom audio system with waterproof speakers (2)
- Clear view hatch to aft cockpit
- Wind deflector screens
- Stainless-steel handrails with glass balustrade and teak capping to aft end of flybridge
- Liferaft stowage on aft rails

- LED deck level lighting
- GRP radar arch
- Twin matching whip aerials for VHF R/T and radio
- Console and seat covers
- Optional crane (550Kg SWL)
- Optional GRP hardtop with/without electric opening section (or optional folding bimini with electro-hydraulic operation

WHEELHOUSE

- Twin leather upholstered helm seats with fore and aft adjustment for helmsman
- U-Shaped seating area to port with table
- Instrument console with LED display incorporating engine instruments, fuel gauges, alarms and rudder position indicator
- Dual station instruments and controls at Flybridge and Lower Helm Positions:
  - power-assisted electro-hydraulic steering
  - adjustable steering wheel
  - high-speed magnetic compass
  - electronic engine controls
  - trim tab controls with indicators
  - bow thruster control
  - hydraulic anchor winch remote control
  - colour radar (with scanner) and GPS/ chart plotter (twin displays at lower helm)
  - autopilot
  - speed and distance log
  - echo sounder with alarm
  - VHF with DSC R/T with intercom



DETAILED SPECIFICATION

- remote control searchlight
- horn button
- Intercom to flybridge
- Automatic fog horn with loudhailer
- Chart storage
- Drinks holders
- Toughened glass screen (clear for night vision) with windscreen de-mist system
- Windscreen wipers with freshwater windscreen wash
- Black mesh sunscreens
- Bilge pump controls with visual pump running warnings
- 24v and 240v electrical control panel
- Riding light, helm and navigation light control switches
- USB connection points (2)
- LED overhead lighting (24V) and night lighting
- Pantograph helmsman’s door to starboard side deck
- Electric drop window to port
- Timber flooring

DECK SALOON

- Twin L-shaped sofas with integrated drawers
- Coffee tables x 2
- Two seater sofa to starboard with integrated drawers
- Storage units
- UHD LED TV (55”) on rise and fall
- Naim Uniti Atom audio system with ceiling mounted speakers (4)
- Triple stainless steel framed sliding door to aft cockpit

- Electric roller sheer blinds to outboard windows
- Electric curtains on wave track to doors
- LED overhead and concealed lighting (24V)
- Fitted carpet

DINING AREA

- Expandable dining table
- Dining chairs (8)
- Sideboard unit with bottle and glass storage
- Refrigerator
- Full height panoramic window
- Electric roller sheer blinds to forward starboard window
- Electric curtains on wave track to panoramic window
- LED overhead and concealed lighting (24V)
- Stairway to lower accommodation
- Day head
- Fitted carpet

GALLEY

- Granite/Quartz worktop
- Open bar/servery layout with powered electric screen to fully enclose galley and with sliding door
- 4-zone Induction hob
- Hob extractor
- Combination microwave/ convection oven with grill
- Twin-bowl stainless-steel sink with mixer

- tap
- Chopping board
- Full height refrigerator/deep freezer
- Dishwasher
- Icemaker
- Waste bin
- Drawers and storage cupboards
- Electric venetian blinds to windows
- Pantograph door to port side deck
- LED overhead and task lighting (24V)
- 220/240v outlets (4)
- ‘V’ groove timber flooring

ACCOMMODATION

- All cabins and bathrooms feature opening portholes and air conditioning
- All cabins feature 220/240v power points
- All bathrooms feature electric freshwater toilets and 240v shaver points

MASTER STATEROOM

- Large double bed with drawers below
- Twin bedside tables
- Dressing area with wardrobes and storage
- Built in safe
- Dressing table with chair (doubles as additional dining chair)
- Mirror
- Occasional table with seats fore and aft
- Storage lockers and drawers
- 55” UHD LED TV
- Naim Uniti Atom audio system with speakers (2) and subwoofer
- Electric roman blinds and manual sheer

- roller blinds to hull windows
- Panoramic windows including opening portholes
- LED overhead and concealed lighting (24V)
- Individual berth lights
- 220/240v outlets (2)
- USB connection points (2)
- Fitted carpet

EN SUITE BATHROOM

- Twin washbasins with Marble/Granite/ Quartz worktop
- Mirror
- Storage lockers
- Separate compartment with toilet and option of bidet
- Shower compartment with automatic pump out
- Extractor fan
- Heated towel rail
- Window with opening porthole
- Manual tension venetian blind
- LED overhead and concealed lighting (24V)
- Bathroom accessories
- Marble/Granite/Quartz to floor and aft specified bulkheads



DETAILED SPECIFICATION

FORWARD STATEROOM

- Large double bed with drawers below
- Walk-in wardrobe with shelves
- Dressing table with chair (doubles as additional dining chair)
- Mirror
- Storage lockers
- 32” HD LED TV
- Naim Uniti Atom sound system with Bluray CD/DVD player paired with ceiling mounted speakers (2)
- Windows with opening portholes
- Electric roman blinds
- Deck hatch
- LED overhead and concealed lighting (24V)
- Individual berth lights
- 220/240v outlets (2)
- USB Connection points (2)
- Fitted carpet

EN SUITE BATHROOM

- Washbasin with Marble/Granite/Quartz worktop
- Mirror
- Storage lockers
- Shower compartment with automatic pump out
- Extractor fan
- Opening porthole
- Manual tension venetian blind
- LED overhead and concealed lighting (24V)
- Bathroom accessories
- Marble/Granite/Quartz flooring and specified bulkhead

STARBOARD GUEST CABIN

- Two single beds with drawers below (with option of double bed conversion)
- Bedside table
- Wardrobe with shelves
- Mirror
- Storage lockers
- Opening portholes
- Electric roman blinds
- LED overhead and concealed lighting (24V)
- Individual berth lights
- 220/240v outlets (2)
- USB Connection points (2)
- Fitted carpet

EN SUITE BATHROOM

- Washbasin with Marble/Granite/Quartz worktop
- Mirror
- Storage lockers
- Shower compartment with automatic pump out
- Extractor fan
- Opening porthole
- Manual tension venetian blind
- LED overhead and concealed lighting (24V)
- Bathroom accessories
- Marble/Granite/Quartz flooring and specified bulkhead

PORT GUEST CABIN

- Large double bed with drawers
- Twin bedside tables
- Dressing table with stool
- Wardrobe with shelves
- Mirror
- Storage lockers
- Opening portholes
- Electric roman blinds
- LED overhead and concealed lighting (24V)
- Individual berth lights
- 220/240v outlets (2)
- USB Connection points (2)
- Fitted carpet

EN SUITE BATHROOM

- Washbasin with Marble/Granite/Quartz worktop
- Mirror
- Storage lockers
- Shower compartment with automatic pump out
- Extractor fan
- Opening porthole
- Manual tension venetian blind
- LED overhead and concealed lighting (24V)
- Bathroom accessories
- Marble/Granite/Quartz flooring and specified bulkhead

CREW QUARTERS

(N.B. All lower deck crew furniture is in white finish, with white solid surface bathroom vanity unit tops and white tiled bathroom floors)

CAPTAIN’S CABIN

- Single bed with storage below (option of additional berth above)
- Wardrobe with shelf
- Mirror
- Storage lockers
- Opening porthole and venetian blind
- LED overhead lighting (24V)
- Individual berth light
- 220/240v outlets (2)
- USB Connection points (2)
- Fitted carpet

CREW CABIN

- Two single beds with storage below
- Wardrobe with shelf
- Mirror
- Storage lockers
- Opening porthole and venetian blind
- LED overhead lighting (24V)
- Individual berth light
- 220/240v outlets (2)
- USB Connection points (2)
- Fitted carpet



DETAILED SPECIFICATION

CREW BATHROOM

- Washbasin with solid surface worktop
- Mirror
- Storage lockers
- Shower compartment with automatic pump out
- Extractor fan
- LED overhead lighting (24V)
- Bathroom accessories
- Tiled flooring

CREW AREA

- Access from transom door and starboard side deck
- Access to engine room
- Storage space, cupboards and lockers
- Dinette sofa with folding table
- Crew mess with Microwave, sink, refrigerator and waste bin
- Washing machine and separate tumble dryer
- LED overhead lighting (24V)
- Altro non slip safety flooring

POWER AND DRIVE SYSTEM

- Engine room soundproofed
- High volume air intakes
- Engine room extractor fan with electronic time delay
- Engine exhaust silencers and water-cooled exhausts
- Engine beds integrally moulded with hull for strength and vibration absorption

- Forward and aft engine room bulkheads integrally bonded
- Engines flexibly mounted
- Automatic fire extinguisher with remote override control
- Automatic and manual bilge pumps
- Propeller shafts in Marinemet
- 5-bladed propellers in nickel aluminum bronze
- High speed balanced rudders
- Cathodic protection for sterngear
- Sterngear, engines, fuel tank fillers, etc all electrically bonded
- Engine room lighting
- Engine room access from crew area and from starboard side deck and transom via crew area
- Power-assisted electro-hydraulic steering system
- Trim tabs with indicators
- Electronic engine and gear shift controls
- Bow thruster (350kgf/771 lbf) with dual-station controls
- Fresh water supply point in engine room
- Dripless self aligning shaft seals

ELECTRICAL SYSTEMS

- 24 VOLT:
- 2 x heavy-duty batteries for engine starting and windlass operation
  - 6 x heavy-duty auxiliary batteries
  - Battery link facility with remote control at helm position
  - Both battery banks are charged using a voltage sensitive relay that parallels both battery banks when a charging source is

- present
- 2 x 60-amp 24v battery chargers
  - Remote battery master switches with control switch at main switch panel
  - Circuit breakers on all circuits
  - 12v voltage dropper for certain navigation and radio circuits
- 220/240 VOLT:
- 27kW generator in own sound shield with water-cooled and specially silenced exhaust
  - 2 x 63-amp shore support inlet
  - Generator/shore support change-over switch
  - Polarity check system
  - Earth leakage safety trip
  - Circuit breakers on all circuits
  - Power points (240v) in: owner’s stateroom, guest cabins, galley and saloon area
  - Shaver points in all bathrooms

FUEL SYSTEM

- Total fuel capacity is 11000 litres/2420 gallons/2905 US gallons comprising 8100 litre main tank and 2 x 1450 litre day tanks
- Fuel polishing transfer system to day tanks with water and vacuum sensors connected to alarms at both helms
- Fuel fillers to port and starboard
- High-capacity duplex fuel filters/water traps with integral changeover valves and water sensors connected to alarms at both helm positions
- Remote fuel isolation controls in cockpit locker for main engines and generators

- Dual station fuel gauges on helm consoles with additional back up mechanical sight gauge fitted to main fuel tank

WATER SYSTEM

- Water tanks totalling 285 gallons/342 US gallons/1295 litres plus 45 gallons/54 US gallons/205 litres hot water calorifier
- 240v immersion heater
- Automatic water pump with filter
- Main circuit breaker at switch panel
- Water level gauge
- Deck filler
- Electric WC system with 132 gallons/158 US gallons/600 litres holding tank, content gauge and low noise electric overboard discharge, with macerator backup system as well as dockside discharge system

FIRE EXTINGUISHERS

- Automatic/manual override fire extinguishers in engine room with warning system at both helm positions and incorporating engine air vent closure system
- Hand operated fire extinguishers (9) in owners stateroom, forward stateroom, port and starboard guest cabins, crew cabins (2), crew mess, galley and wheelhouse



# DETAILED SPECIFICATION

## BILGE PUMPS

- Automatic/manual override electric bilge pumps in engine room (2), rudder area and forward accommodation (8 in all)
- High-capacity manual bilge pump with valve system and suction points in same areas
- Electric bilge pumps have controls and warning lights at main helm and warning light with audible alarm at flybridge helm

## OTHER STANDARD EQUIPMENT

- Ensign staff
- Fenders (8)
- Mooring warps (4)
- Boathook
- First Aid kit
- Tool kit
- Owner’s manual and engine manual
- Quilted bedspreads supplied to all cabins (except crew cabin)
- Set of towels (8 large, 8 hand)
- Complete set of Lucrezia crystal glassware (8 settings consisting of tumbler, highball and wine glasses)
- Set of Sous Le Soleil crockery (8 settings consisting of plate, cake plate, dessert plate, bowl, cup & saucer)
- Set of stainless steel cutlery (8 settings of David Mellor “Paris” cutlery 7 pieces)
- Ship’s document case
- Anchor winch back up handle

## FINISHES

- Teak-laid decks to transom platform, cockpit deck, steps to side decks, side decks and foredeck walkthrough, steps to flybridge and flybridge
- ‘V’ grooved timber-laid floor to galley and helm
- Furniture in choice of Alba oak, Rovere oak or walnut wood with satin or gloss lacquer finishes
- Marble/Granite/Quartz floors in all bathroom suites in guest accommodation
- Marble/Granite/Quartz wash hand basin counter tops in all bathroom suites in guest accommodation
- Galley worktop in Granite/Quartz
- Choice of high quality carpet and fabrics from extensive range
- Curtains, blinds or sunscreens to all windows and portholes
- Crew cabins have fitted carpet, crew bathroom floor is white tiled with white Solid surface countertops

Please note the right is reserved to add modify or delete from this preliminary specification.



# OPTION FORM

Included with this Product Platform Document is an electronic version of the preliminary option form which is for use in face-to-face meetings with clients only.

## Princess Y85

### ORDER PRICING - STANDARD OPTIONS

August 2018

DISTRIBUTOR: .....

**IMPORTANT** The boat must be specified by the date given on the Order Form. An item requested after that date may be too late for the normal boat build sequence, which means either it may not be possible to fit at all, or the cost may be greater as it will have to be retrofitted.

Exc. VAT

**ENGINES & DRIVE**

Please state engine type required : .....

☐ JOYSTICK AVENTICS (Dual Station)  
(operates both engines, bowthruster and optional stern thruster) £19,500.00

**HYDRAULICS**

Standard hydraulic system (consisting of separate engine driven hydraulic pumps on each engine with cross connections allowing any system to be supplied with hydraulic power from either engine) combining the bowthruster (with proportional speed control) & windlass system

☐ Hydraulic Sternthruster (variable speed 340 KgF) £9,300.00

**STABILISATION**

☐ Sleipner Hydraulic system (consisting of separate engine driven hydraulic pumps on each engine with cross connections allowing any system to be supplied with hydraulic power from either engine) and incorporating SPS92/VF1350 vector fin stabilizer system. When underway fins are driven by engine powered hydraulic pumps and at zero speed by a generator powered electric motor. £165,000.00

This system is designed to provide roll control at speeds above 12 knots as well as zero speed stabilisation. Bow and Stern thrusters feature fully proportional speed control. When the main engines are turned off the hydraulics are powered by an electric motor (2 x 27.5kW generators are recommended)

☐ Gyro stabilisation (Seakeeper NG35)  
(additional generator is recommended) £215,250.00

**HULL COLOUR**

Canopy style line painted in Graphite Grey and main deck window graphics painted in Onyx Black

☐ White  
(with dark grey water line, black antifouling, hull & bathing platform fendering is white with stainless steel insert) N.E.C.

Princess Y85

STANDARD OPTIONS

August 2018

..... YARD NO: .....

date given on the Order Form. An item requested after normal boat build sequence, which means either it may not be greater as it will have to be retrofitted.

Exc. VAT

Black & black  
Steel insert & bathing  
Hull will be post cured,  
metallic finish.  
£138,000.00

to despatch to the  
(delivery date) The

Grey water line &  
less steel insert &  
Hull will be post  
ft non metallic finish  
£158,700.00

to despatch to the  
(delivery date) The

Wheelhouse floors are N.E.C.

Wheelhouse floors are N.E.C.

Wheelhouse floors are £9,600.00

Wheelhouse floors are £9,600.00

Wheelhouse floors are £15,900.00

Wheelhouse floors are £15,900.00

Wood in place of £4,440.00

Saloon & Dining area floors to be in V Groove painted wood with inlaid rug\* in aft saloon area (wood type same as galley & wheelhouse) £8,000.00

Saloon & Dining area floors to be in V Groove Wenge wood with inlaid rug\* in aft saloon area £16,000.00

Issue Date: 03/09/2018

Page 1 of 17

U2:MP300(93)(08/2018)

Issue Date: 03/09/2018

Page 2 of 17

U2:MP300(93)(08/2018)

Issue Date: 03/09/2018

Page 3 of 17

U2:MP300(93)(08/2018)



ADVANCED INFORMATION PACK

Customer Facing

PRINCESS Y85 MOTOR YACHT  
PRODUCT PLATFORM DOCUMENT

PRINCESS

INTERNAL USE ONLY - STAGE 1 - 01.09.18

LAYOUTS

Highlights of the Princess Y85 Motor Yacht:

- Expansive main deck layout with flexible party arrangement for open family boating or closed for more formal occasions with full crew
- Beautifully appointed master stateroom with aftership bathroom incorporating large stall shower (and optional bath) and separate toilet compartment
- Separate enclosed wheelhouse
- Crew quarters with crew mess, captain's cabin, bunk cabin and bathroom with separate stall shower
- Main deck day head
- Side access doors to side decks from helm and galley areas
- Teak-laid flybridge, deck areas and bathing platform
- Wide side decks and high bulwarks
- Foredeck seating and sunbathing area with adjustable headrests (convertible to aft facing U-shaped seating area)
- High quality finish including granite-quartz flooring in all guest bathrooms

FLYBRIDGE

MAIN DECK

LOWER DECK

Distributor Only

PRINCESS Y85 MOTOR YACHT  
ADVANCED INFORMATION PACK

PRINCESS

INTERNAL USE ONLY - 01.09.18

The optional electro hydraulic transom platform has a 550kg safe working load capacity. It is fitted as standard and can accommodate a tender with a maximum weight of 550kg, like the Williams Turbobout 445 or the Williams Sport Jet 435.

MAIN COMPETITORS

	Princess Y85 Motor Yacht	Ferretti 850	Azimut 80	Sunseeker 86	San Lorenzo 86	MCY 86
LOA	84'6" / 25.78m	85'3" / 26.0m	82'6" / 25.2m	86'3" / 26.3m	87'8" / 26.76m	86" / 26.3m
Beam	20'9" / 6.3m	20'7" / 6.28m	20'3" / 6.18m	21'3" / 6.47m	20'9" / 6.35m	21'2" / 6.40m
Draft	5'9" / 1.77m	6'6" / 2.0m	5'8" / 1.72m	6'5" / 1.95m	6'3" / 1.9m	6'3" / 1.9m
Displacement (kg)	66,500	77,450	64,000	67,000	66,000	72,000 (light)
Fuel (L)	11,000	6,750	6,000	11,000	8,400	7,100
Fresh Water (L)	1,500	1,320	1,100	1,400	1,700	1,500
Engine	MAN V12 1800	MAN V12 1800	MAN V12 1550	MTU 12V 1924	MTU 10V 1622	MAN V12 1800
Maximum Speed (kn)	32	29	28	30	28	29
Number of Cabins	4	4	4	4	4	3-5
Number of Heads	5	5	5	5	5	5

The Advanced Information Pack and Sales Layout Drawing can be shared with prospects and an electronic version is included in this Product Platform Document.



## FOR FURTHER INFORMATION

PLEASE CONTACT:

Your respective sales manager

### Information disclaimer:

The details contained in this document were correct at the time of publication. Princess Yachts Limited reserves the right to modify or change the specification.





